

SIMONWORK

BTO 900

mobile

95,7 x 91 x 61 cm

37.7" x 35.8" x 24.0"



5 Años Garantía
Years Guarantee
Jahre Garantie
Ans Garantie
Anos de Garantía
SIMONRACK

CAPACITÀ TOTAL DELLO SCAFFALE
CAPACITÈ TOTAL DE L'ETRIAGE
CAPACITY TOTAL LOAD
DE LA ESTANTERIA DE PROFUNDITAT
CAPACIDAD TOTAL DE PROFUNDITAT
120 KG



95.7 cm (37.7")

61 cm (24.0")

91 cm (35.8")

Carga uniformemente repartida
Evenly distributed load
Gleichmäßig verteilte Last
Charge uniformément répartie
Carga uniformemente distribuida



1 x 60x90 cm
23.6" x 35.4"
1 x 35x90 cm
13.8" x 35.4"

1 x 90 cm
35.4"

14 x

4 x 84 cm
33.1"

4 x 90 cm
35.4"
4 x 60 cm
23.6"

2 x

2 x

14 x

*MEDIDAS EN USO USED MEASUREMENTS
MASSNAHMEN IM EINSAZ MESURES EN EMPLOI MEDIDAS EN USO:
959 x 910 x 610 mm (37.3" x 35.8" x 24")



ESTANTERIAS SIMON S.L. B.60.556.463
PG. ALFAMEN CI POLIGONO C. Nº3
ALFAMEN (ZARAGOZA)



www.simonrack.com



INSTRUCCIONES
INSTRUCTIONS
ANLEITUNG
INSTRUCTIONS

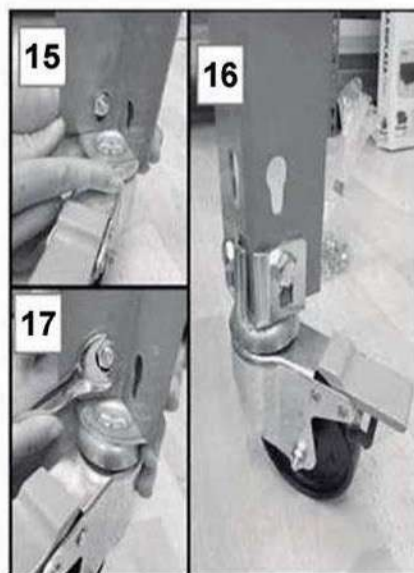
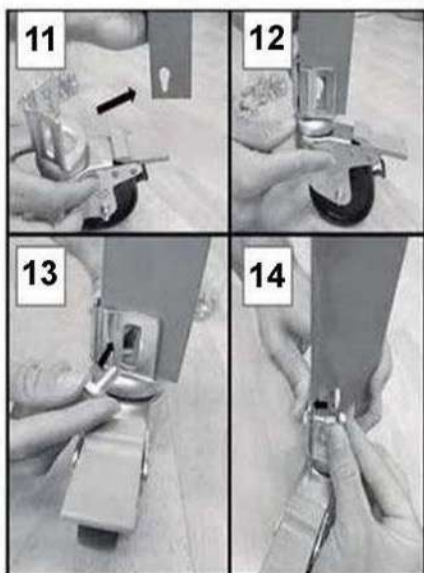
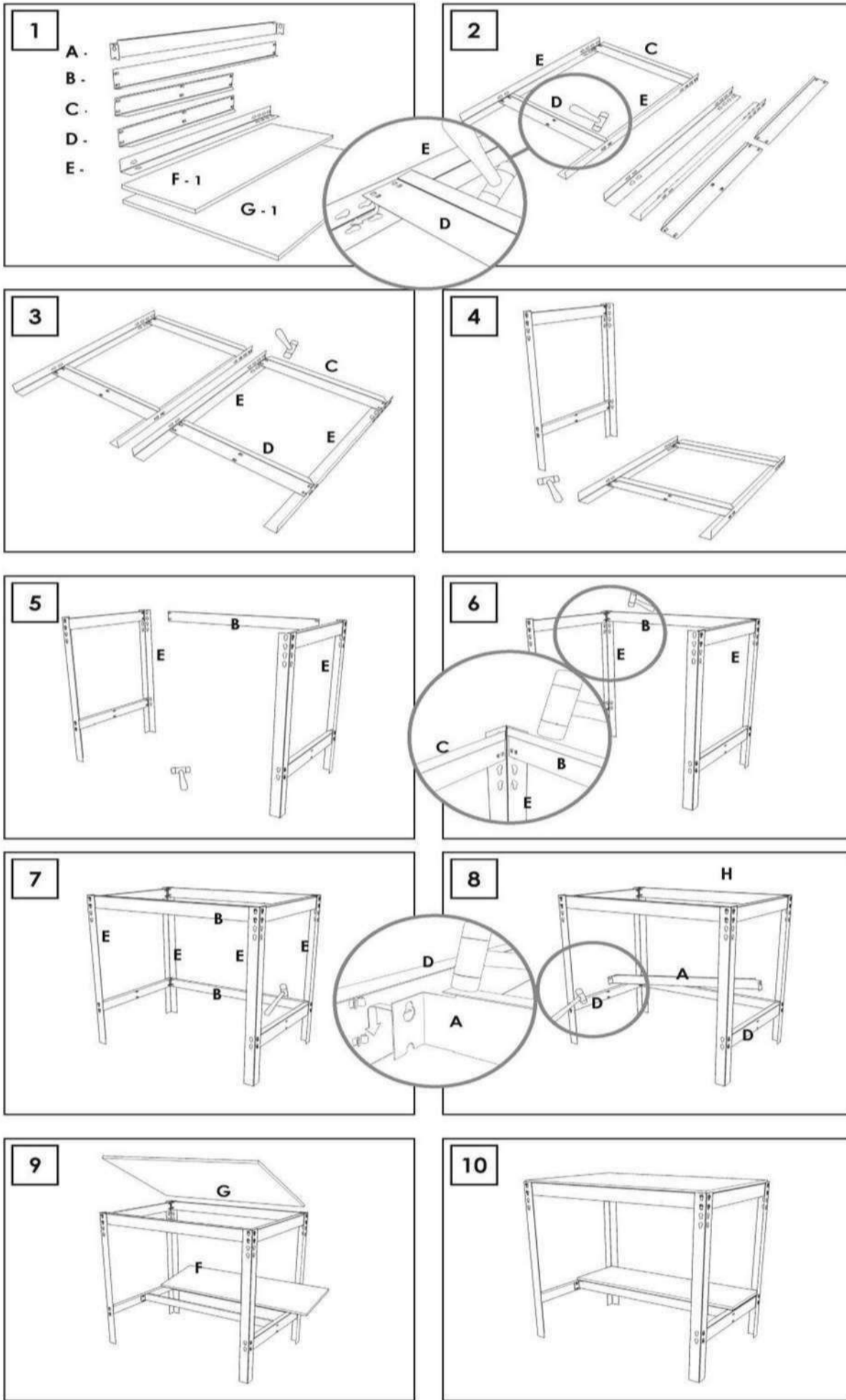

SIMONCLASSIC

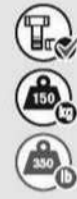

SIMONCLICK



SIMONTALLER



SIMONAUTO



SIMONWORK



SIMONLOCKER



SIMONOFFICE



SIMONHOME



SIMONGARDEN



SIMONTITAN



SIMONINOX



SIMONINDUSTRIAL

SIMONPALET



SIMONLEVER



AL TILLOS Y PASILLOS ELEVADOS
PLATFORMS AND MEZZANINES
LAGERBÜHNEN • PLATES-FORMES ET MEZZANINES



* Kg / lb por bandeja con carga uniformemente repartida
Kg / lb per shelf uniformly distributed load
Kg / lb pro fach bei gleichmäßig verteilter last
Kg / lb par plateau avec charge uniformément répartie

