

SIMONWORK

BTO 1200

mobile

95,7 x 121 x 76 cm

37.7" x 47.6" x 29.9"



5 Años Garantía
Years Guarantee
Jahre Garantie
Ans Garantie
Anos de Garantia

SIMONRACK

CAPACITÀ TOTALE DELLO SCAFFALE
120 KG
CAPACITÀ TOTALE L.L.D.D. CAPACITY
DE LA ESTANTERIA
CAPACIDAD TOTAL



Carga uniformemente repartida
Evenly distributed load
Gleichmäßig verteilte Last
Charge uniformément répartie
Carga uniformemente distribuida

95.7 cm (37.7")

76 cm (29.9")

121 cm (47.6")



1 x 75 x 120 cm
MDF 29.5" x 47.2"
1 x 35 x 120 cm
13.8" x 47.2"

1 x 75 cm
120 cm
29.5"
47.2"

14 x

4 x 84 cm
33.1"

4 x 120 cm
47.2"
75 cm
29.5"

2 x

2 x

14 x

*MEDIDAS EN USO USED MEASUREMENTS
MASSNAHMEN IM EINSATZ MESURES EN EMPLOI MEDIDAS EN USO:
843 x 1210 x 760 mm (33.19" x 47.63" x 29.9")



ESTANTERIAS SIMON S.L. B.60.566.463
PG. ALFAMEN CI POLIGONO C. Nº3
ALFAMEN (ZARAGOZA)

Simon Rack
SINCE 1964 - MANUFACTURER



www.simonrack.com



INSTRUCCIONES
ANLEITUNG
INSTRUCTIONS

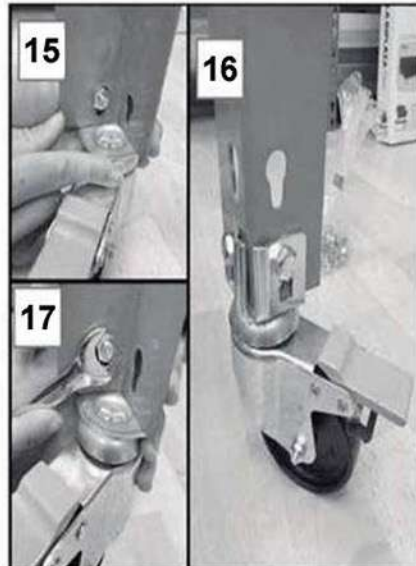
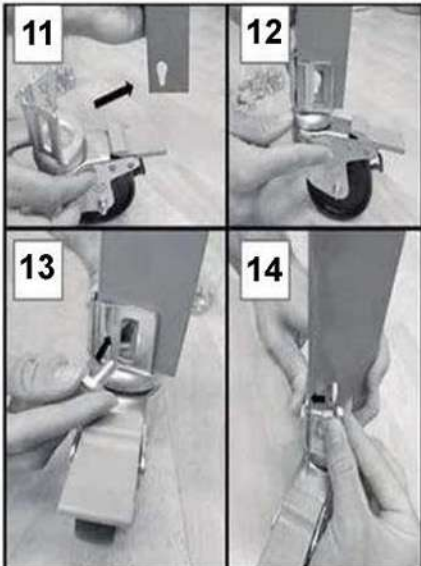
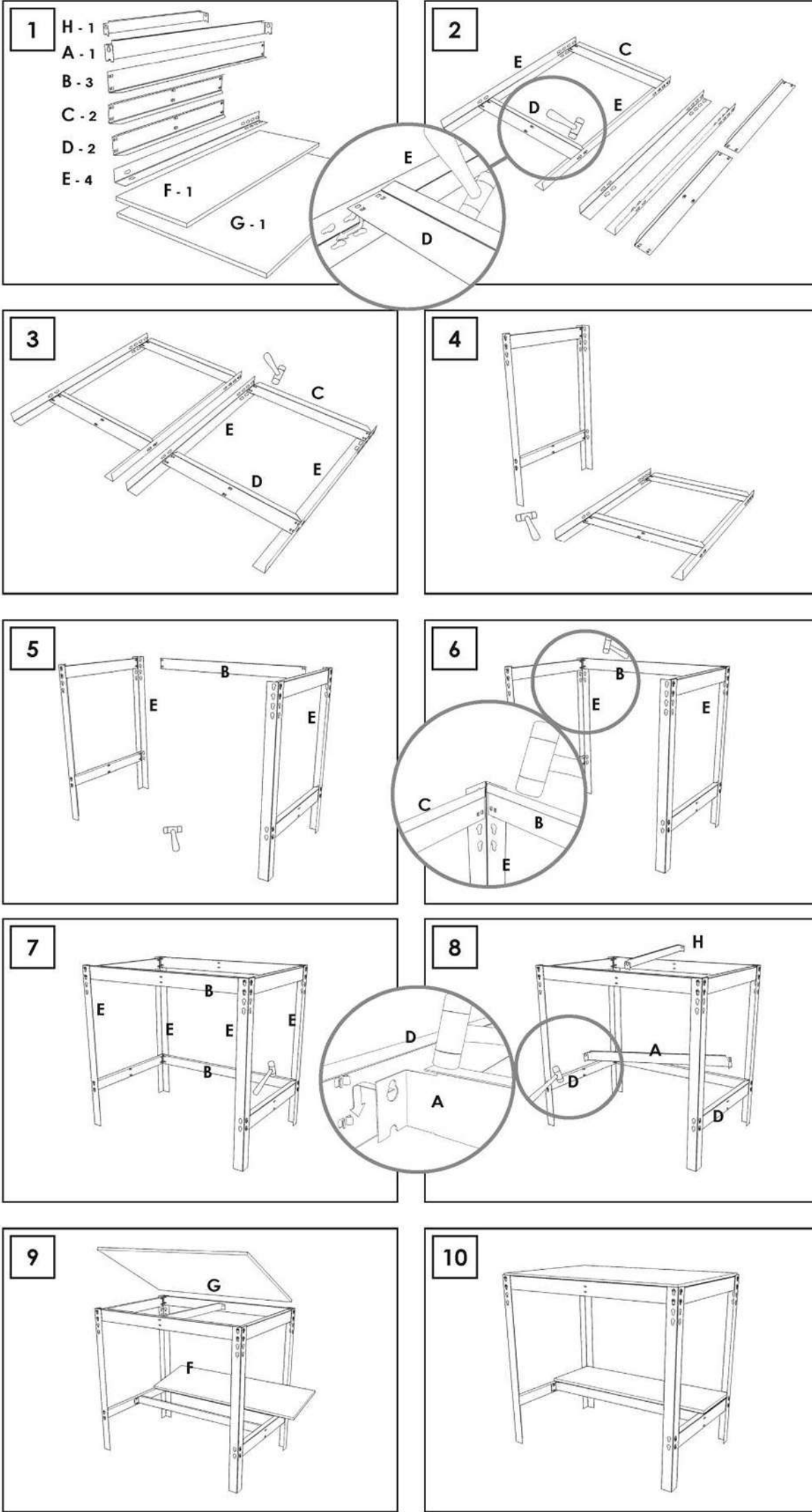

SIMONCLASSIC



SIMONCLICK



SIMONTALLER



SIMONAUTO



SIMONWORK



SIMONLOCKER



SIMONOFFICE



SIMONHOME



SIMONGARDEN



SIMONTITAN



SIMONINOX



SIMONINDUSTRIAL

SIMONPALET



SIMONLEVER



ALTILLOS Y PASILLOS ELEVADOS
PLATFORMS AND MEZZANINES
LAGERBUHNEN • PLATES-FORMES ET MEZZANINES



* Kg / lb por bandeja con carga uniformemente repartida
Kg / lb per shelf uniformly distributed load
Kg / lb pro fach bei gleichmäßig verteilter Last
Kg / lb par plateau avec charge uniformément répartie