

160x166x40 cm

63.0" x 65.4" x 15.7"

SIMONINOX 5PP

5 Años Garantía
Years Guarantee
Jahre Garantie
Ans Garantie
Anos de Garantía
SIMONRACK



160 cm (63.0")

40 cm (15.7")

166 cm (65.4")

180 kg
(400 lb)

180 kg
(400 lb)

180 kg
(400 lb)

180 kg
(400 lb)

180 kg
(400 lb)

1400 kg
(3100 lb)
Total



ESTANTERIAS SIMON S.L. B.50.556.463
PG. ALFAMEN C/ POLIGONO C, N°3
ALFAMEN (ZARAGOZA)



www.simonrack.com



INSTRUCCIONES
INSTRUCTIONS
ANLEITUNG
INSTRUCTIONS

STANDARD INSTRUCTIONS PP

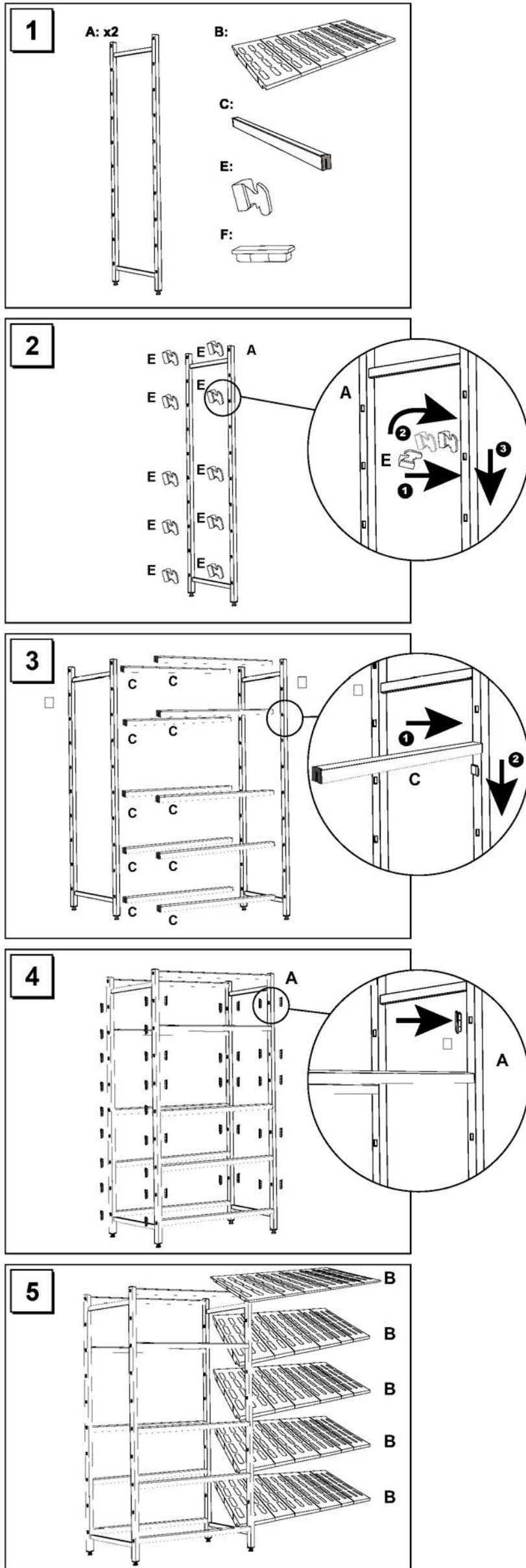

SIMONCLASSIC	
SIMONCLICK	
SIMONTALLER	
SIMONAUTO	
SIMONWORK	
SIMONLOCKER	
SIMONOFFICE	
SIMONHOME	
SIMONTITÁN	SIMONINOX
SIMONINDUSTRIAL	
SIMONPALET	SIMONLEVER
<p>ALTILLOS Y PASILLOS ELEVADOS PLATFORMS AND MEZZANINES LAGERBÜHNEN • PLATES-FORMES ET MEZZANINES</p>	

www.simonrack.com • www.instructionsrack.com



* Kg / lb por bandeja con carga uniformemente repartida
Kg / lb per shelf uniformly distributed load
Kg / lb pro fach bei gleichmäßig verteilter Last
Kg / lb par plateau avec charge uniformément répartie