

200x126x40 cm

78.7"x49.6"x15.7"

SIMONINOX 5PP

5 Años Garantía
Years Guarantee
Jahre Garantie
Ans Garantie
Anos de Garantía
SIMONRACK



200 cm (78.7")

40 cm (15.7")

126 cm (49.6")

1400 kg (3100 lb) Total



- 2 x 200 cm (78.7")
- 5 x 120x40 cm (47.2"x15.7")
- 10 x 120 cm (47.2")
- 20 x
- 60 x

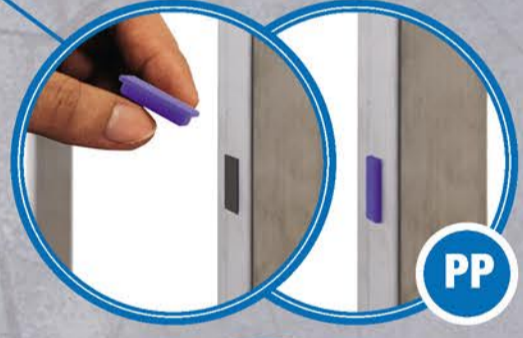

ESTANTERIAS SIMON S.L. B.50.556.463
PG. ALFAMEN C/ POLIGONO C, N°3
ALFAMEN (ZARAGOZA)



www.simonrack.com



INSTRUCCIONES
INSTRUCTIONS
ANLEITUNG
INSTRUCTIONS

STANDARD INSTRUCTIONS PP

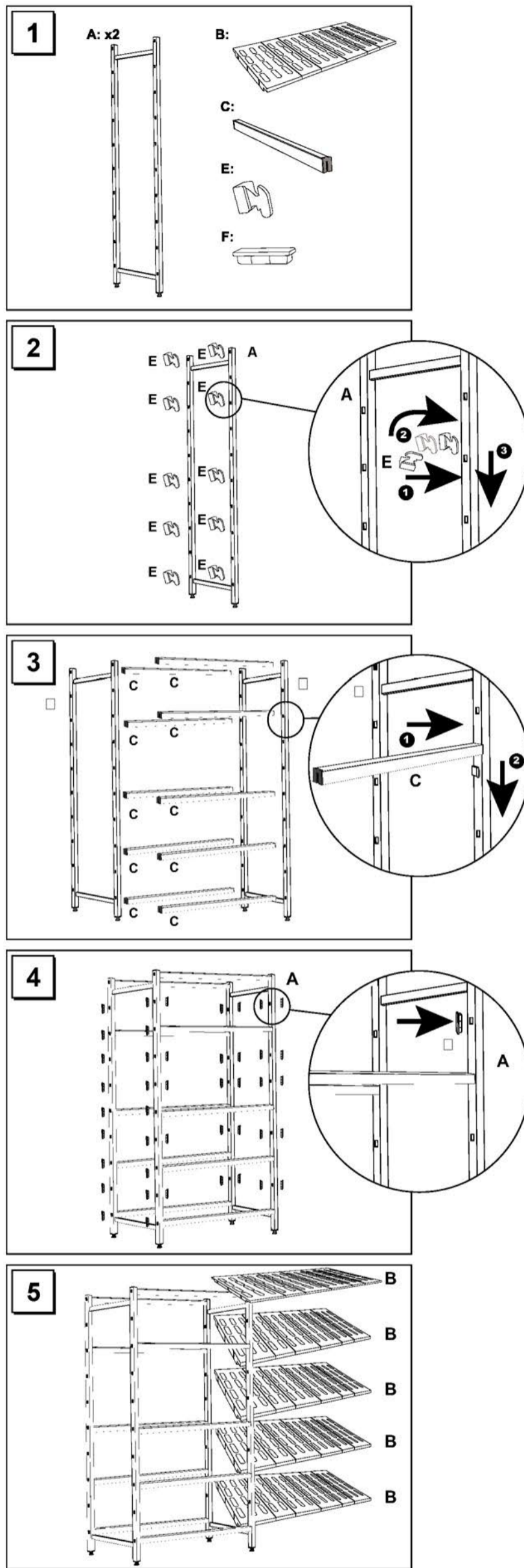

www.simonrack.com • www.instructionsrack.com/simoninox

SIMONCLASSIC 150 kg / 330 lb	
SIMONCLICK 400 kg / 900 lb	
SIMONTALLER 700 kg / 1550 lb	
SIMONAUTO 300 kg / 660 lb	
SIMONWORK 800 kg / 1800 lb	
SIMONLOCKER 275 kg / 600 lb	
SIMONOFFICE 150 kg / 330 lb	
SIMONHOME 600 kg / 1350 lb	
SIMONGARDEN 600 kg / 1350 lb	
SIMONTITÁN 900 kg / 1980 lb	SIMONINOX 4500 kg / 9900 lb
SIMONINDUSTRIAL SIMONPALET SIMONLEVER 4500 kg / 9900 lb ALTILLOS Y PASILLOS ELEVADOS PLATFORMS AND MEZZANINES LAGERBÜHNEN • PLATES-FORMES ET MEZZANINES * Kg / lb por bandeja con carga uniformemente repartida Kg / lb per shelf uniformly distributed load Kg / lb pro fach bei gleichmäßig verteilter Last Kg / lb par plateau avec charge uniformément répartie	

