

150 x 90 x 40 cm

59.1" x 35.4" x 15.8"

SIMONCLICK 4/400

5 Años Garantía
Years Guarantee
Jahre Garantie
Ans Garantie
Anos de Garantia
SIMONRACK



720 kg
(1587 lb)
Total



*MEDIDAS EN USO USED MEASUREMENTS
MASSNAHMEN IM EINSATZ MESURES EN EMPLOI MEDIDAS EN USO:
1495 x 910 x 410 mm (58.8" x 35.8" x 16.1")



ESTANTERIAS SIMON S.L. B.50.556.463
PG. ALFAMEN C/ POLIGONO C, Nº3
ALFAMEN (ZARAGOZA)

www.simonrack.com *



www.simonrack.com



INSTRUCTIONS

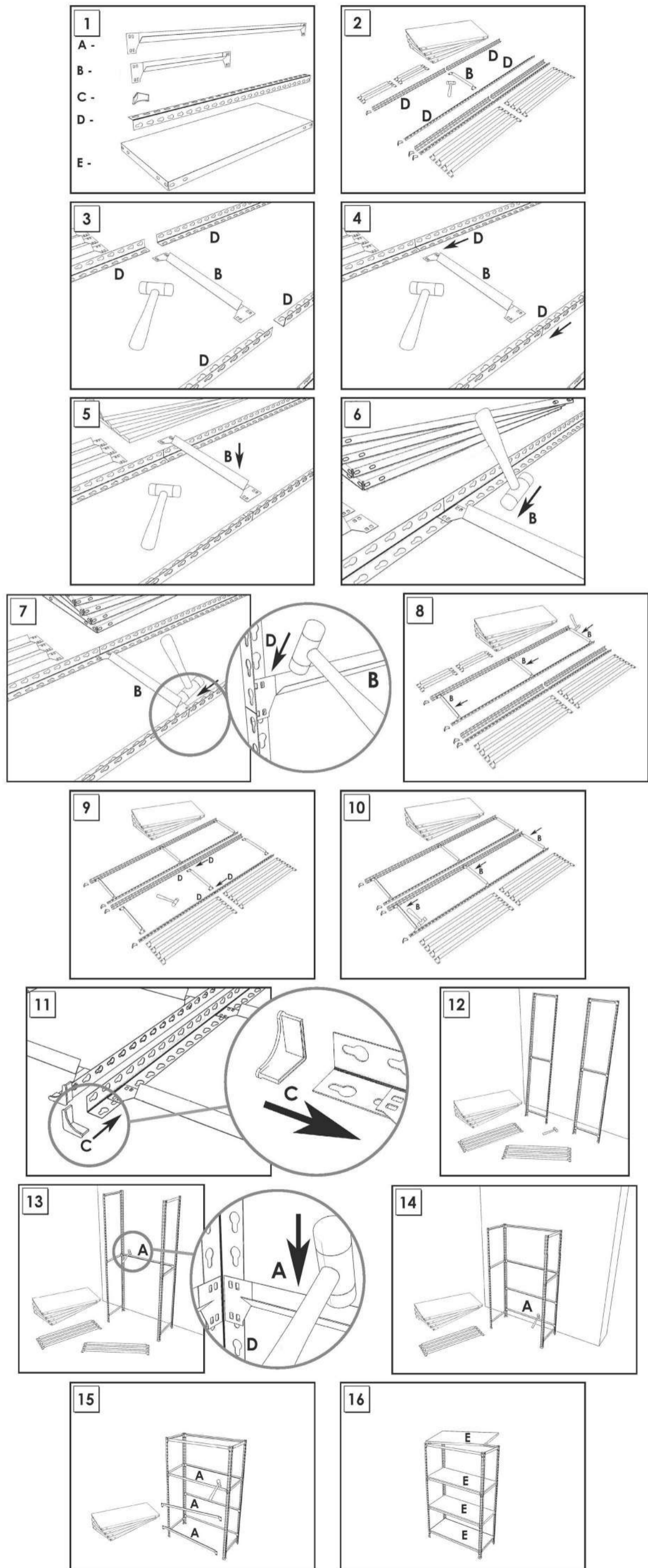

On-line instructions: www.instructionsrack.com/simonclick

SIMONCLASSIC
 BOLTS SYSTEM
 Up to: **150 Kg** (331 lb) Kg/Shelf
 Uniformly Distributed Load

SIMONCLICK
 NO BOLTS SYSTEM
 Up to: **400 Kg** (882 lb) Kg/Shelf
 Uniformly Distributed Load

SIMONOFFICE
 NO BOLTS SYSTEM
 Up to: **275 Kg** (606 lb) Kg/Shelf
 Uniformly Distributed Load

SIMONTALLER
 NO BOLTS SYSTEM
 Up to: **700 Kg** (1543 lb) Kg/Shelf
 Uniformly Distributed Load

BANCOS DE TRABAJO WORK BENCHES
 Up to: **800 Kg** (1764 lb) Kg/Shelf
 Uniformly Distributed Load

SIMONHOME
 Up to: **150 Kg** (331 lb) Kg/Shelf
 Uniformly Distributed Load

TAQUILLAS LOCKER

SIMONTITÁN
 NO BOLTS SYSTEM
 Up to: **900 Kg** (1984 lb) Kg/Shelf
 Uniformly Distributed Load

SIMONINOX
 NO BOLTS SYSTEM

SIMONPALET
 Up to: **4500 Kg** (9921 lb) Kg/Shelf
 Uniformly Distributed Load

SIMONLEVER

ALTILLOS Y PASILLOS ELEVADOS PLATFORMS AND MEZZANINES