

100 x 100 x 30 cm

39.3" x 39.3" x 11.8"

KIT SIMONBOTTLE SHELF 1-2



300 kg
(660 lb)
Total

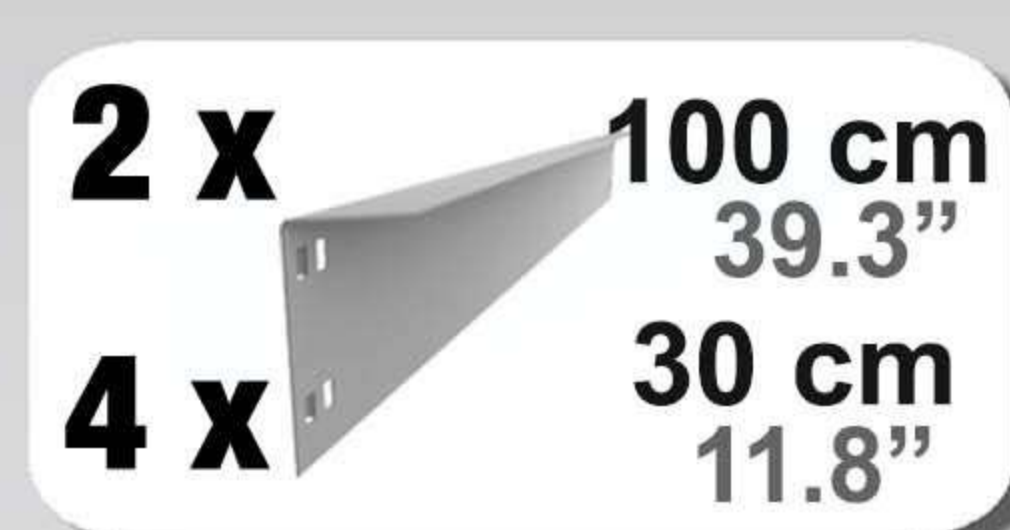
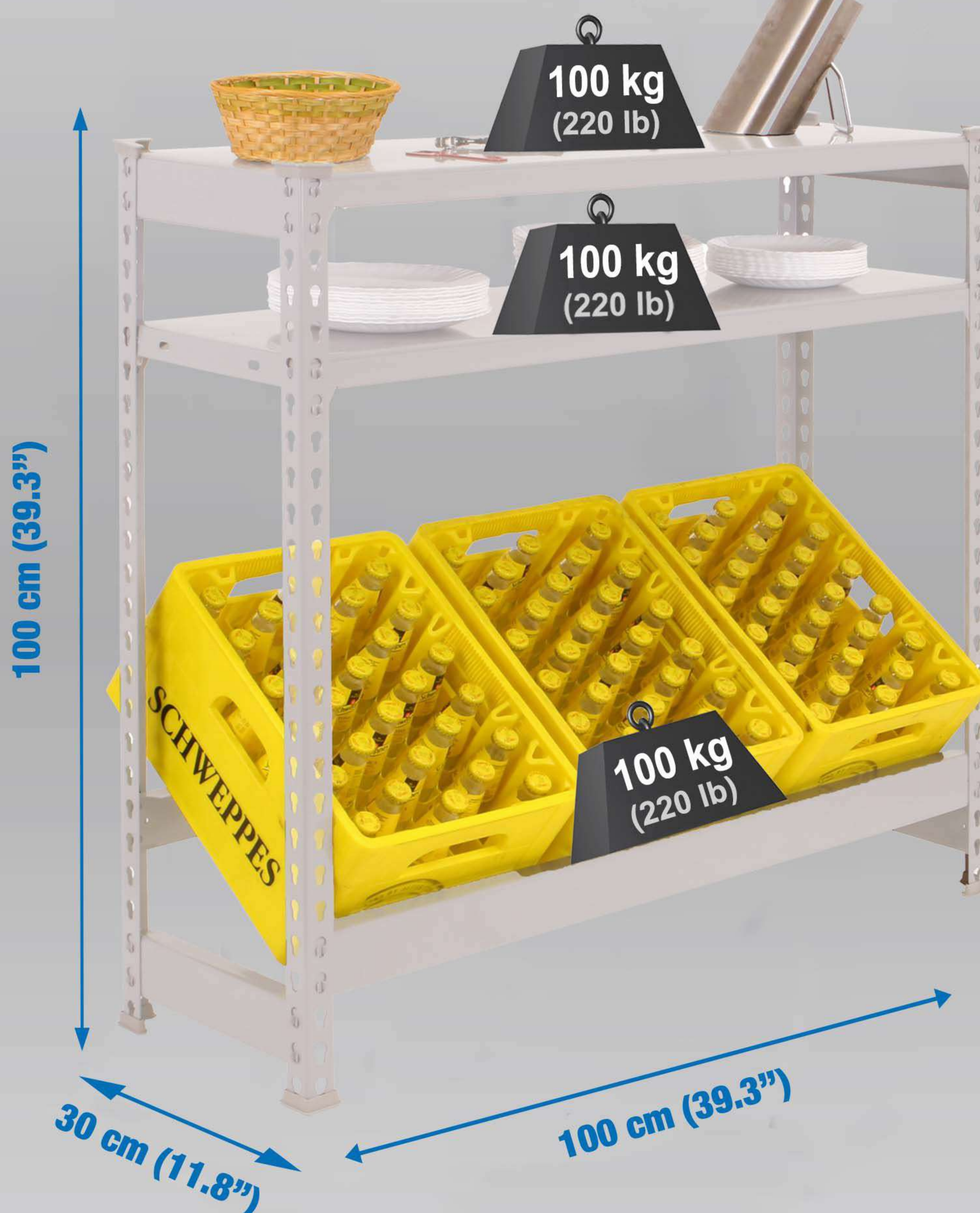

*MEDIDAS EN USO • USED MEASUREMENTS
MASSNAHMEN IM EINSATZ • MESURES EN EMPLOI • MEDIDAS EM USO:
1010 x 1010 x 310 mm (39.7" x 39.7" x 12.2")



Simon
Rack
SINCE 1964 - MANUFACTURER

ESTANTERIAS SIMON S.L. B.50.556.463
PG. ALFAMEN C/ POLIGONO C, Nº3
ALFAMEN (ZARAGOZA)



INSTRUCCIONES
INSTRUCTIONS
ANLEITUNG

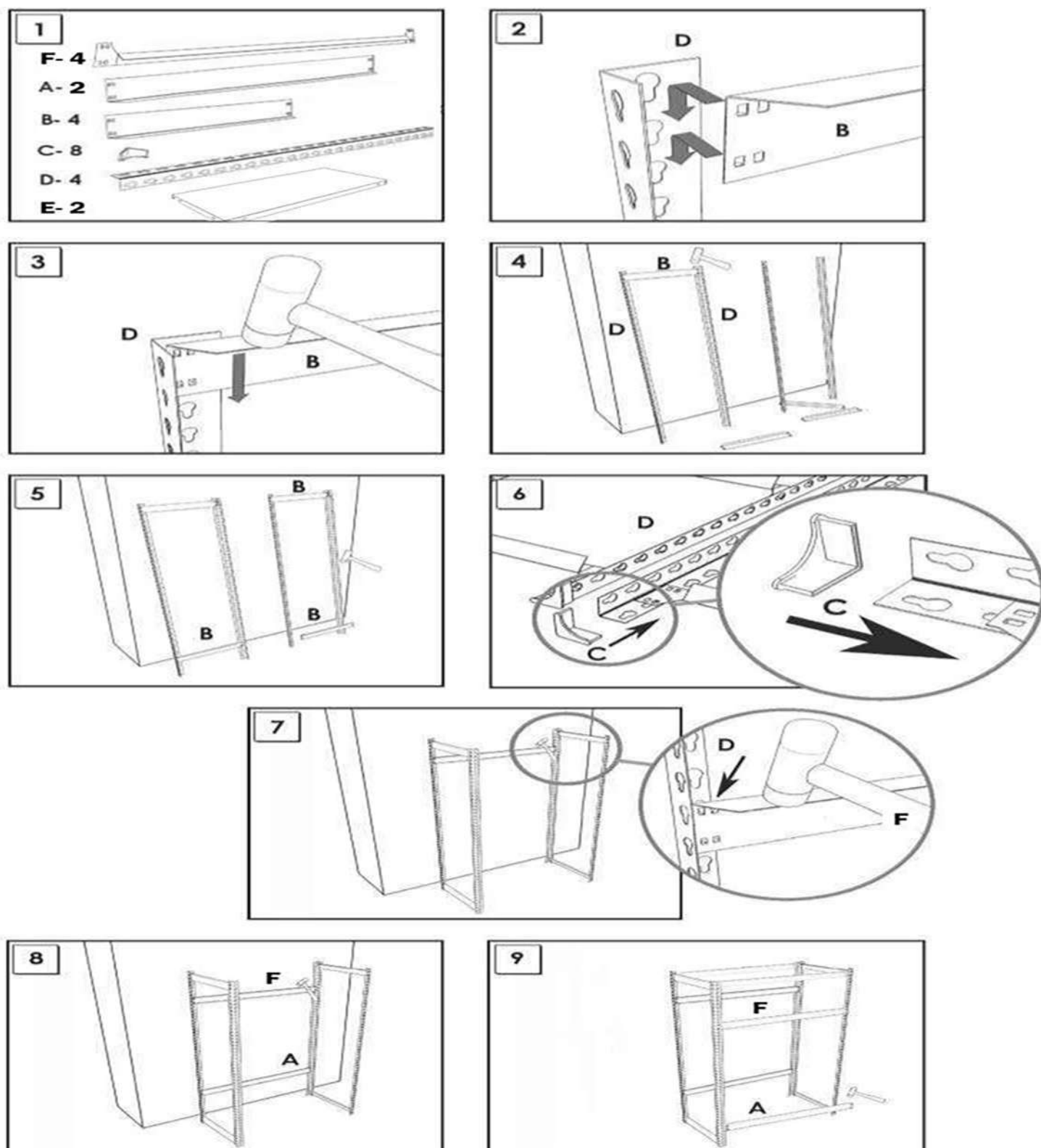

www.simonrack.com • www.simonrack.com • www.simonrack.com • www.simonrack.com

| | | | |
|-------------------------------------|------------------------------------|------------------------------------|--|
| SIMONCLASSIC | SIMONCLICK | SIMONTALLER | SIMONAUTO |
| SIMONWORK | SIMONLOCKER | SIMONOFFICE | SIMONHOME |
| SIMONGARDEN | SIMONTITÁN | SIMONINOX | SIMONINDUSTRIAL |

* Kg / lb por bandeja con carga uniformemente repartida • Kg / lb per shelf uniformly distributed load • Kg / lb pro fach bei gleichmäßig verteilter Last • Kg / lb par plateau avec charge uniformément répartie