

90 x 120 x 30 cm

35.4" x 47.2" x 11.8"

KIT SIMONCLICK MEGAPLUS 3/300

5 Años Garantía
Years Guarantee
Jahre Garantie
Ans Garantie
Anos de Garantia
SIMONRACK

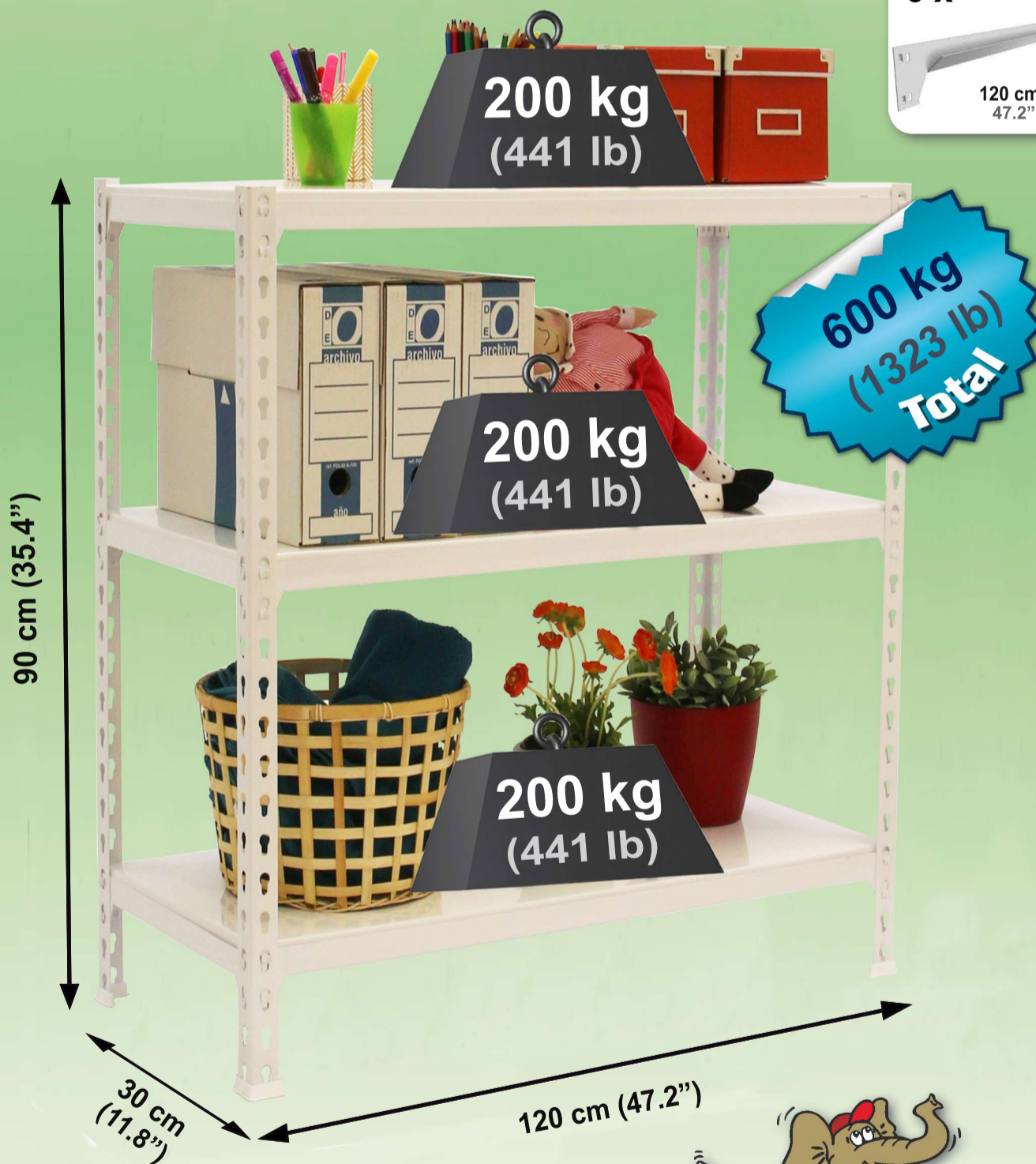

Simon
Rack
SINCE 1964 - MANUFACTURER

ESTANTERIAS SIMON S.L. B.50.556.463
PG. ALFAMEN C/ POLIGONO C, N°3
ALFAMEN (ZARAGOZA)



www.simonrack.com



INSTRUCTIONS

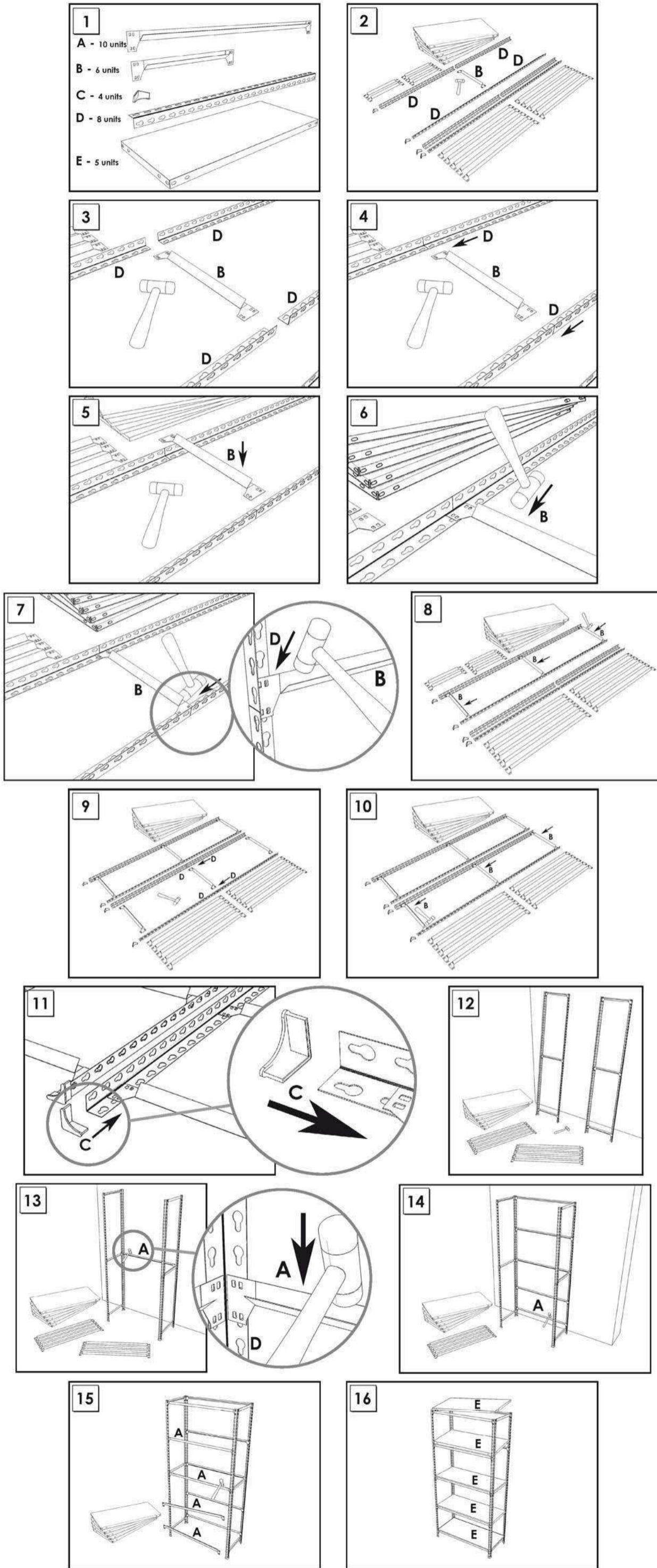

On-line instructions: www.instructionsrack.com/simonclick

SIMONCLASSIC



Up to:
150 Kg
(331 lb)
Kg/Shelf
(Uniformly Distributed Load)

SIMONCLICK



Up to:
400 Kg
(882 lb)
Kg/Shelf
(Uniformly Distributed Load)

SIMONOFFICE



Up to:
275 Kg
(606 lb)
Kg/Shelf
(Uniformly Distributed Load)

SIMONTALLER



Up to:
700 Kg
(1543 lb)
Kg/Shelf
(Uniformly Distributed Load)

**BANCOS DE TRABAJO
WORK BENCHES**

Up to:
800 Kg
(1764 lb)
Kg/Shelf
(Uniformly Distributed Load)



SIMONHOME

Up to:
150 Kg
(331 lb)
Kg/Shelf
(Uniformly Distributed Load)



**TAQUILLAS
LOCKER**



SIMONTITÁN

Up to:
900 Kg
(1984 lb)
Kg/Shelf
(Uniformly Distributed Load)



SIMONINOX

Up to:
900 Kg
(1984 lb)
Kg/Shelf
(Uniformly Distributed Load)



SIMONPALET

Up to:
4500 Kg
(9921 lb)
Kg/Shelf
(Uniformly Distributed Load)



SIMONLEVER



**ALTILLOS Y PASILLOS ELEVADOS
PLATFORMS AND MEZZANINES**

