

160x126x40 cm

63.0" x 49.6" x 15.7"

SIMONINOX 5SS

5 Años Garantía
Years Guarantee
Jahre Garantie
Ans Garantie
Anos de Garantía
SIMONRACK



160 cm (63.0")

40 cm (15.7")

126 cm (49.6")

1400 kg
(3100 lb)
Total

200 kg
(440 lb)

200 kg
(440 lb)

200 kg
(440 lb)

200 kg
(440 lb)

200 kg
(440 lb)

- 2 x 160 cm (63.0")
- 15 x 40x40 cm (15.7"x15.7")
- 10 x 120 cm (47.2")
- 20 x
- 60 x



ESTANTERIAS SIMON S.L. B.50.556.463
PG. ALFAMEN C/ POLIGONO C, N°3
ALFAMEN (ZARAGOZA)



www.simonrack.com



INSTRUCCIONES
INSTRUCTIONS
ANLEITUNG
INSTRUCTIONS

STANDARD INSTRUCTIONS SS

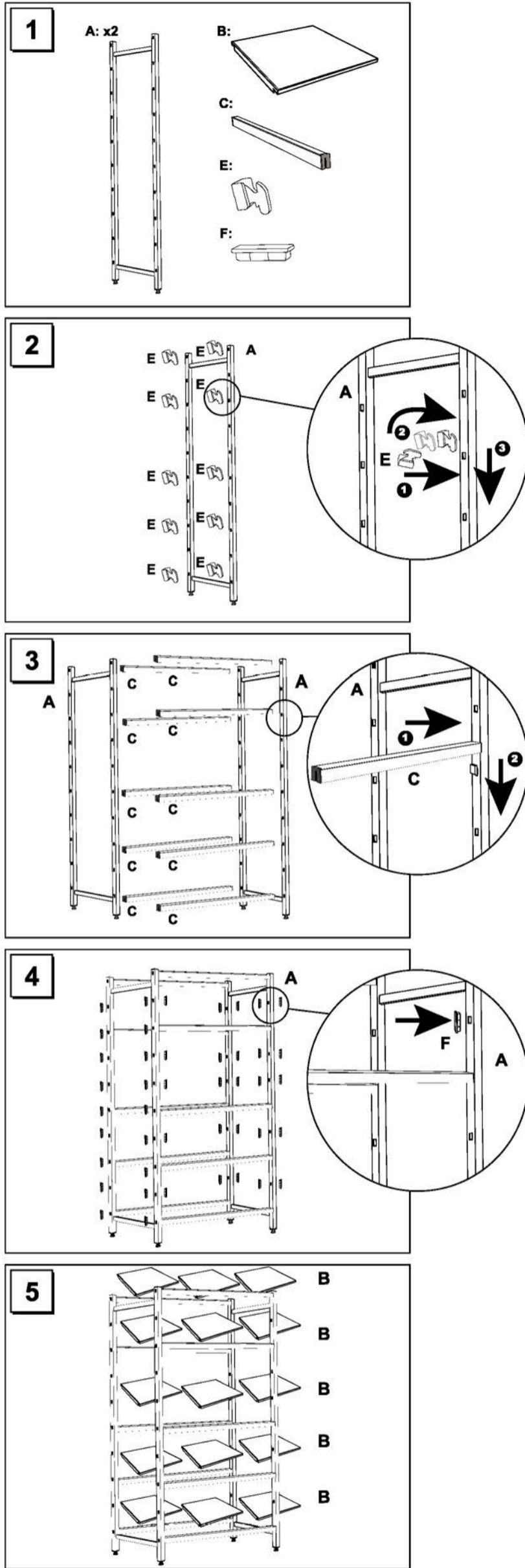

SIMONCLASSIC	
SIMONCLICK	
SIMONTALLER	
SIMONAUTO	
SIMONWORK	
SIMONLOCKER	
SIMONOFFICE	
SIMONHOME	
SIMONGARDEN	
SIMONTITÁN	SIMONINOX
SIMONINDUSTRIAL	
SIMONPALET	SIMONLEVER
ALTILLOS Y PASILLOS ELEVADOS PLATFORMS AND MEZZANINES LAGERBÜHNEN • PLATES-FORMES ET MEZZANINES	

www.simonrack.com • www.instructionsrack.com • www.simoninox.com



* Kg / lb per bandeja con carga uniformemente repartida
 Kg / lb per shelf uniformly distributed load
 Kg / lb pro fach bei gleichmäßig verteilter Last
 Kg / lb par plateau avec charge uniformément répartie