

# 160x166x40 cm

## 63.0" x 65.3" x 15.7"

### SIMONINOX 5SS

**5** Años Garantía  
Years Guarantee  
Jahre Garantie  
Ans Garantie  
Anos de Garantía  
**SIMONRACK**



160 cm (63.0")

40 cm (15.7")

166 cm (65.3")

**1400 kg**  
(3100 lb)  
**Total**

**200 kg**  
(440 lb)

**200 kg**  
(440 lb)

**200 kg**  
(440 lb)

**200 kg**  
(440 lb)

**200 kg**  
(440 lb)

- 2 x 160 cm (63.0")
- 20 x 40x40 cm (15.7"x15.7")
- 10 x 160 cm (63.0")
- 20 x
- 60 x



ESTANTERIAS SIMON S.L. B.50.556.463  
PG. ALFAMEN C/ POLIGONO C, N°3  
ALFAMEN (ZARAGOZA)

**Simon Rack**  
SINCE 1964 - MANUFACTURER



[www.simonrack.com](http://www.simonrack.com)



INSTRUCCIONES  
INSTRUCTIONS  
ANLEITUNG  
INSTRUCTIONS



## STANDARD INSTRUCTIONS SS

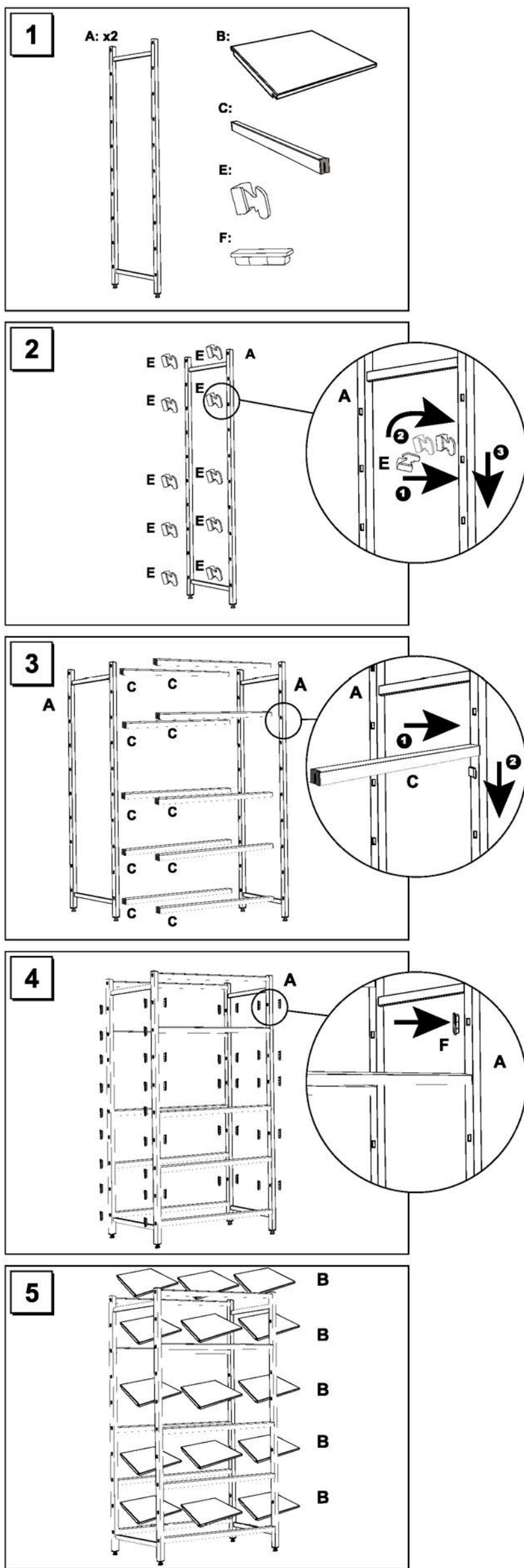

### SIMONCLASSIC



### SIMONCLICK



### SIMONTALLER



### SIMONAUTO



### SIMONWORK



### SIMONLOCKER



### SIMONOFFICE



### SIMONHOME



### SIMONGARDEN



### SIMONTITÁN



### SIMONINOX



### SIMONINDUSTRIAL

#### SIMONPALET



#### SIMONLEVER



ALTILLOS Y PASILLOS ELEVADOS  
PLATFORMS AND MEZZANINES  
LAGERBÜHNEN • PLATES-FORMES ET MEZZANINES

