

# SIMONWORK BTO 900

mobile

95,7 x 91 x 61 cm  
37.7" x 35.8" x 24.0"



**5** Años Garantía  
Years Guarantee  
Jahre Garantie  
Ans Garantie  
Anos de Garantia  
**SIMONRACK**

ESANTTRAGFÄHIGKEIT  
DELO SCAFFALE  
CAPACITÀ TOTALE  
DE LA ESTANTERIA  
DE PRATELERIA  
CAPACIDAD TOTAL  
DE LA ESTANTERIA  
DE PRATELERIA  
CAPACIDAD TOTAL  
**120** KG  
TOTAL LOAD CAPACITY



WHEELS INCLUDED - INCLUI RODAS - RÄDER INKL.  
- INCLUIE RUEDAS - INCLUIE RUOTE



95,7 cm (37.7")



61 cm (24.0")

91 cm (35.8")

Carga uniformemente repartida  
Evenly distributed load  
Gleichmäßig verteilte Last  
Charge uniformément répartie  
Carga uniformemente distribuida

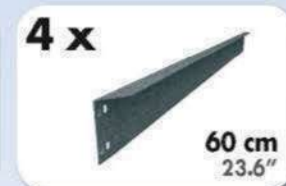

\*MEDIDAS EN USO USED MEASUREMENTS  
MASSNAHMEN IM EINSATZ MESURES EN EMPLOI MEDIDAS EM USO:  
945 x 910 x 610 cm ( 37.20" x 35.8" x 24.0")



ESTANTERIAS SIMON S.L. B. 50.556.463  
PG. ALFAMEN C/ POLIGONO C. Nº3  
ALFAMEN (ZARAGOZA)



www.simonrack.com



INSTRUCCIONES  
INSTRUCTIONS  
ANLEITUNG  
INSTRUCTIONS



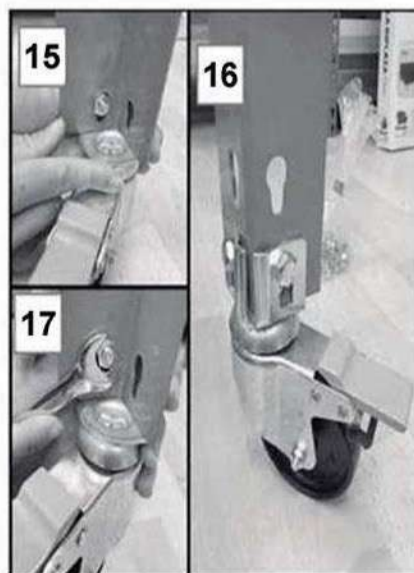
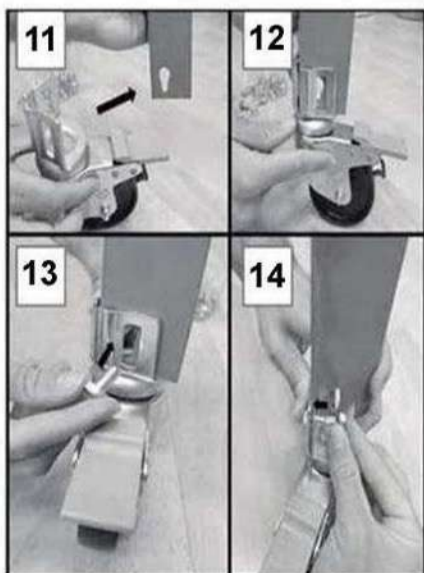
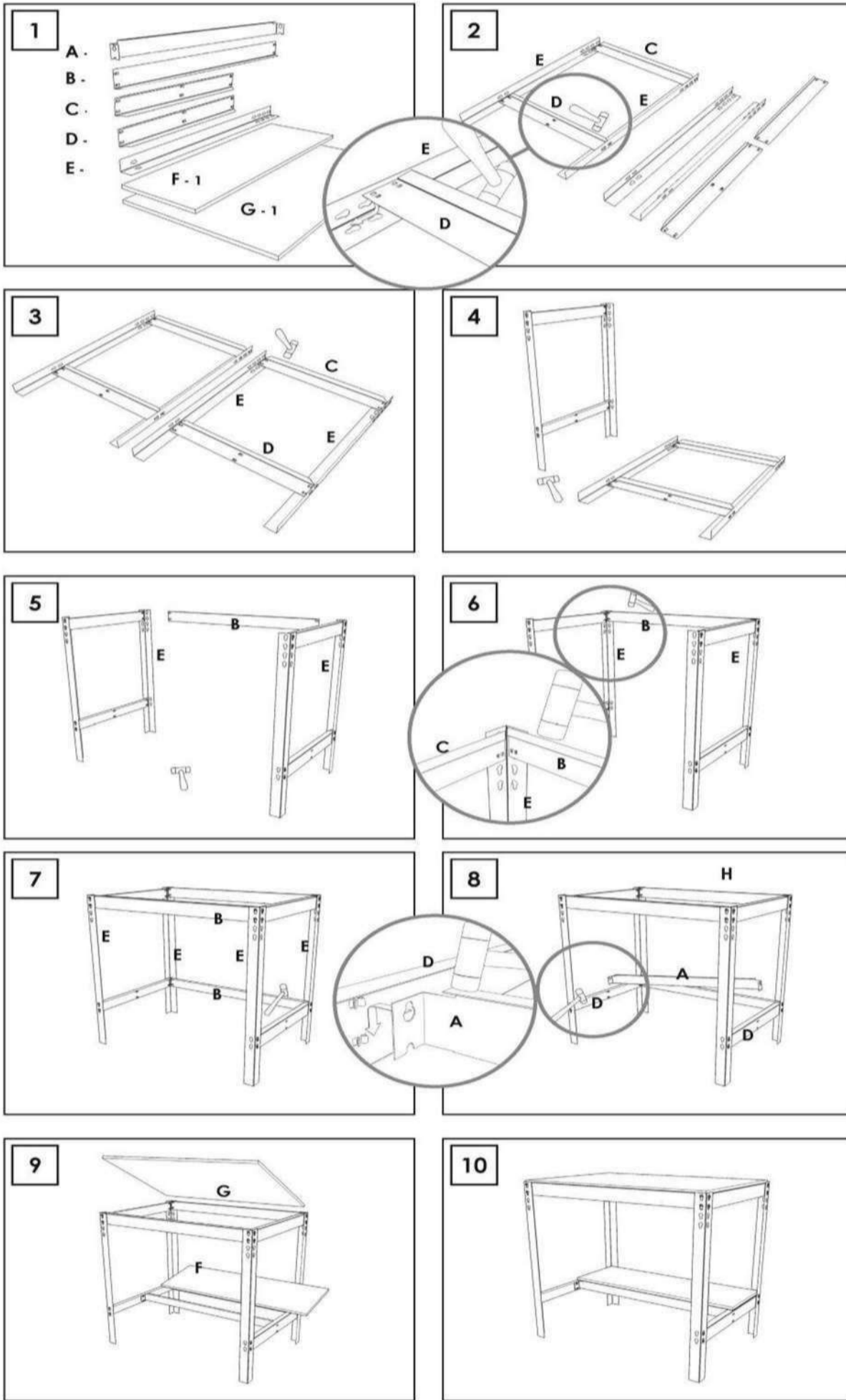

**SIMONCLASSIC**

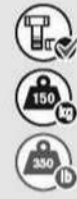

**SIMONCLICK**



**SIMONTALLER**



**SIMONAUTO**



**SIMONWORK**



**SIMONLOCKER**



**SIMONOFFICE**



**SIMONHOME**



**SIMONGARDEN**



**SIMONTITAN**



**SIMONINOX**



**SIMONINDUSTRIAL**



AL TILLOS Y PASILLOS ELEVADOS  
PLATFORMS AND MEZZANINES  
LAGERBÜHNEN • PLATES-FORMES ET MEZZANINES



\* Kg / lb por bandeja con carga uniformemente repartida  
Kg / lb per shelf uniformly distributed load  
Kg / lb pro fach bei gleichmäßig verteilter Last  
Kg / lb par plateau avec charge uniformément répartie

