

# 200x86x50 cm

## 78.7"x33.9"x19.7"

### SIMONINOX 5SS

**5** Años Garantía  
Years Guarantee  
Jahre Garantie  
Ans Garantie  
Anos de Garantía  
**SIMONRACK**



200 cm (78.7")

50 cm (19.7")

86 cm (33.9")



- 2 x  200 cm (78.7")
- 10 x  40x50 cm (15.7"x19.7")
- 10 x  80 cm (31.4")
- 20 x 
- 60 x 

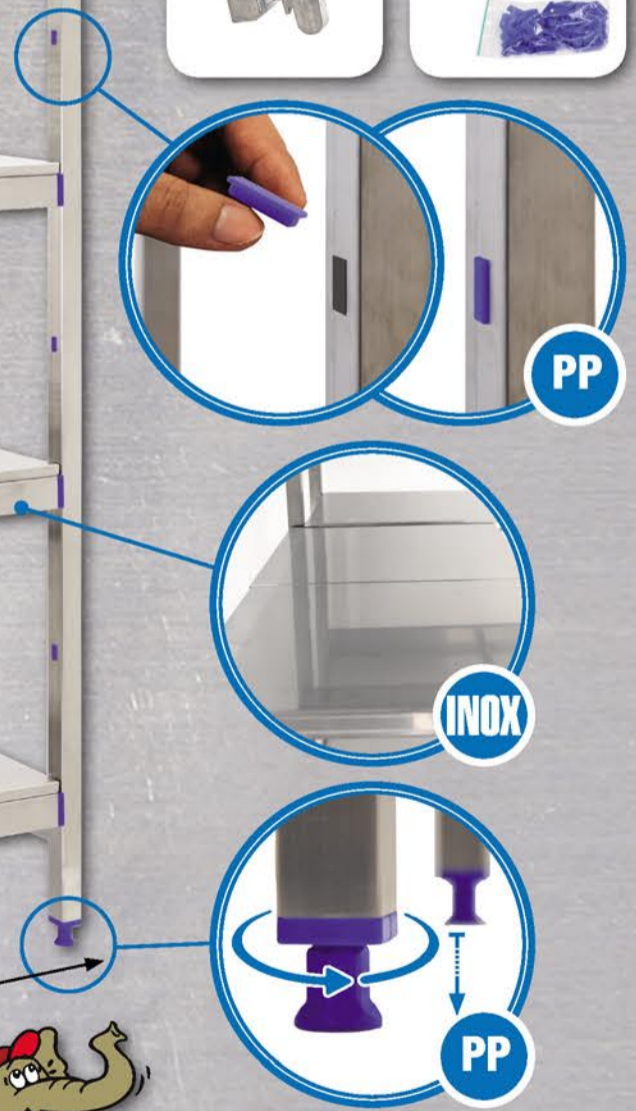

ESTANTERIAS SIMON S.L. B.50.556.463  
PG. ALFAMEN C/ POLIGONO C, N°3  
ALFAMEN (ZARAGOZA)

**Simon**  
**Rack**  
SINCE 1964 - MANUFACTURER



[www.simonrack.com](http://www.simonrack.com)



INSTRUCCIONES  
INSTRUCTIONS  
ANLEITUNG  
INSTRUCTIONS



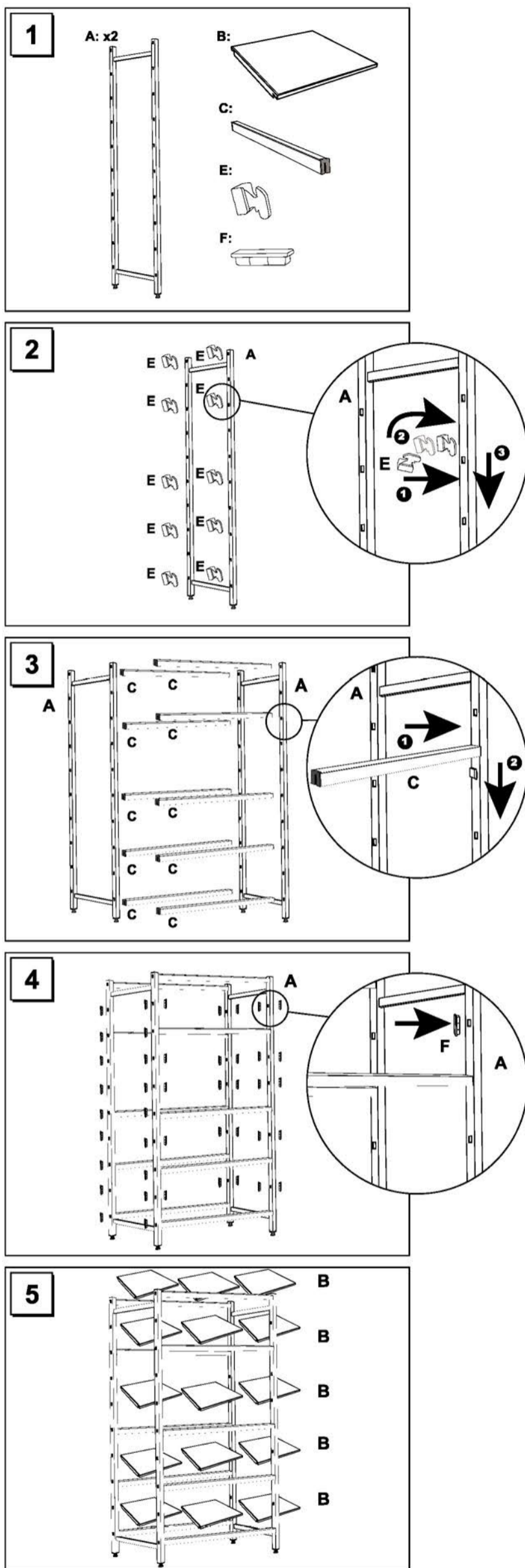

**SIMONCLASSIC**  
150 kg / 330 lb

**SIMONCLICK**  
400 kg / 900 lb

**SIMONTALLER**  
700 kg / 1550 lb

**SIMONAUTO**  
300 kg / 660 lb

**SIMONWORK**  
800 kg / 1800 lb

**SIMONLOCKER**

**SIMONOFFICE**  
275 kg / 600 lb

**SIMONHOME**  
150 kg / 330 lb

**SIMONGARDEN**  
600 kg / 1350 lb

**SIMONTITÁN**  
900 kg / 1990 lb

**SIMONINOX**

**SIMONINDUSTRIAL**  
SIMONPALET: 4500 kg / 9950 lb  
SIMONLEVER

ALTILLOS Y PASILLOS ELEVADOS  
PLATFORMS AND MEZZANINES  
LAGERBÜHNEN • PLATES-FORMES ET MEZZANINES

www.simonrack.com • www.instructionsrack.com



\* Kg / lb por bandeja con carga uniformemente repartida  
Kg / lb per shelf uniformly distributed load  
Kg / lb pro fach bei gleichmäßig verteilter Last  
Kg / lb par plateau avec charge uniformément répartie