

ASSEMBLY

First, check your bicycle tire width.

Put both smile shaped parts onto 1 base leg marked with bicycle types(Road, MTB, MTB+, FATTY)

Double check if you matched the tire width correctly.

If so, add the 2nd base leg to the smile shaped parts.

The product is designed to hold itself strongly without any extra materials, please use a rubber hammer if it's difficult for you to assemble or disassemble the product.

ADJUSTMENT



Both smile-shaped parts have the engraved words WIDE or NARROW on each side.

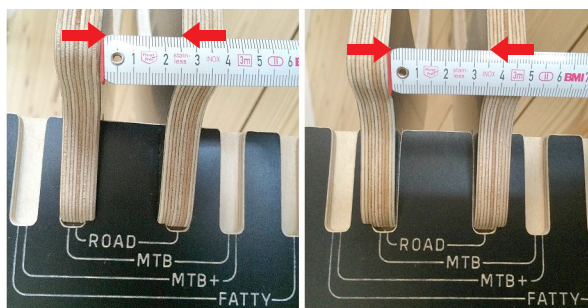

One of the base legs is marked with ROAD, MTB, MTB+, FATTY to make it easier to choose the correct tire width.

Each of the tire positions have two options - WIDE or NARROW.

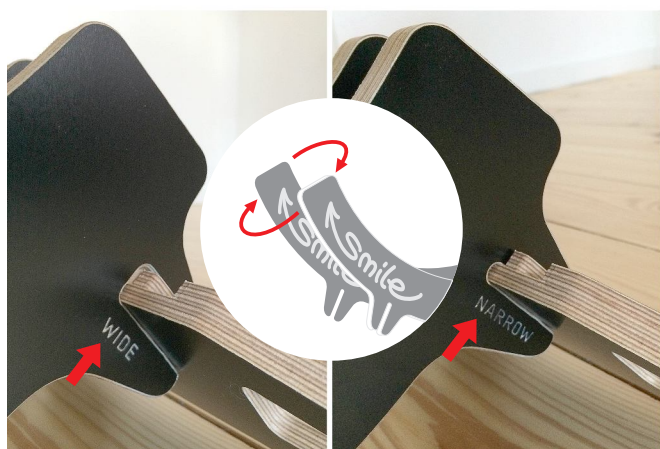

If you assembled the stand according to your bicycle type, but the width is too wide or narrow - you can switch the smile shaped parts in places.

If the engraved words WIDE are on the outside - you make the stand wider.

If the engraved words NARROW are on the outside - you make the stand narrower.

3 possible positions

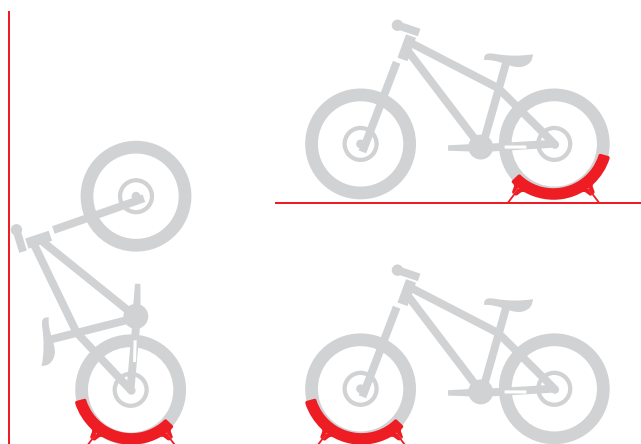

Smile

UNIVERSAL BIKE STAND

www.mtbhopper.com