

INSTALLATION

1. Take the heater out from the package

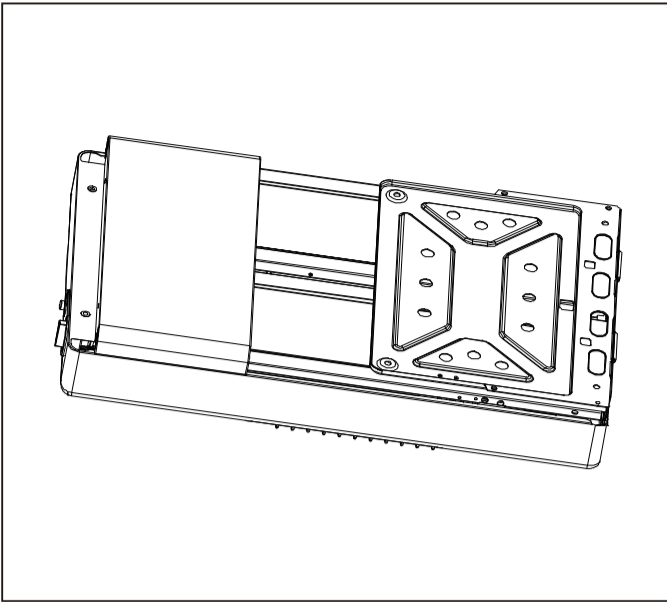

2. Unfold the top panel and baseplate

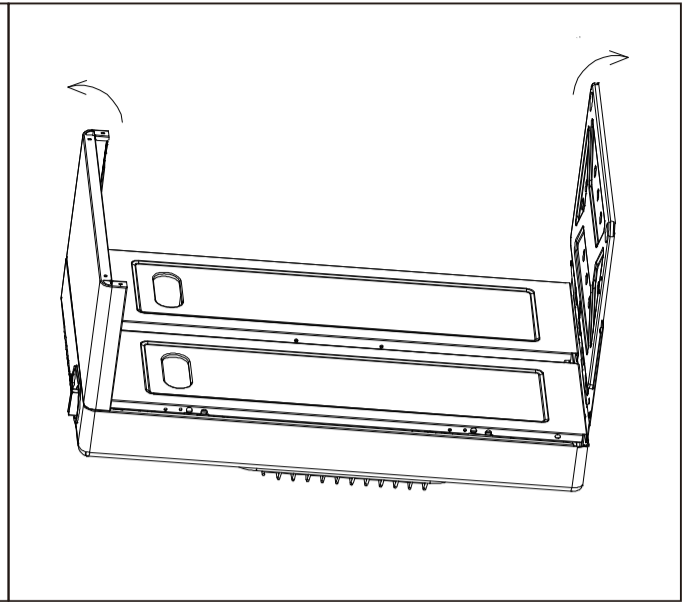

3. Open the side panel and turn the baseplate inside. After that, insert the two hooks of the side panel to the two slot holes of the top panel, then push forward to faster.

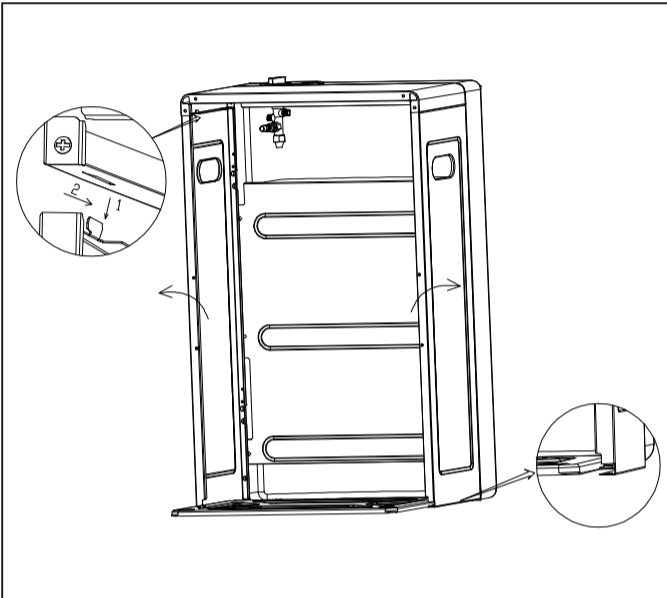

4. Faster the top panel with front panel by 2pcs M5 thumb screws.

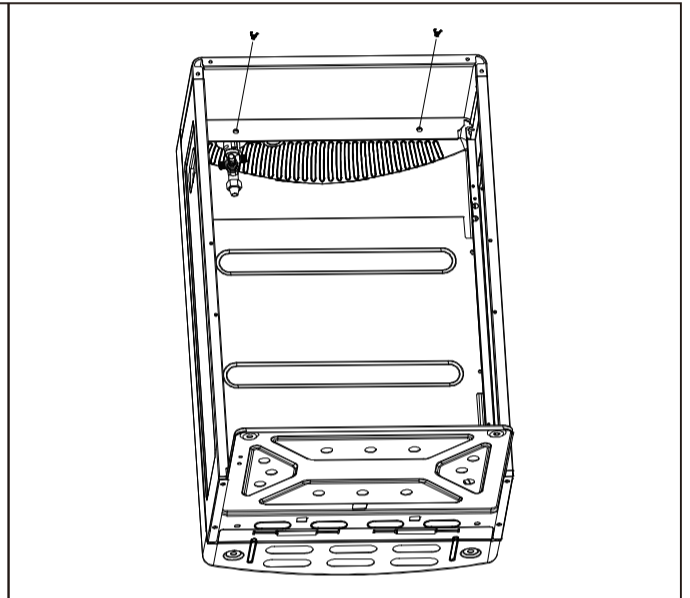

5. Match the side panel with baseplate in four holes, use the screwdriver to fix with 4pcs M5*8 screws.

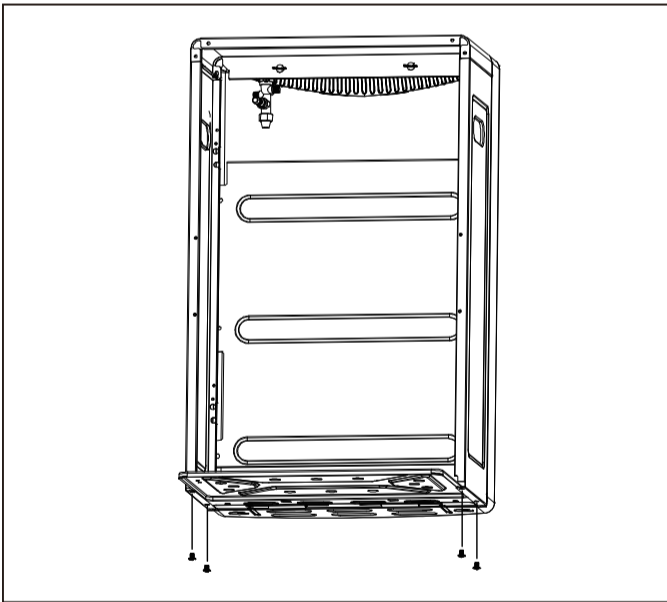

6. Fix the four wheels to the baseplate and front panel, using the spanner to lock the 4pcs M8 nuts to make the heater stably.

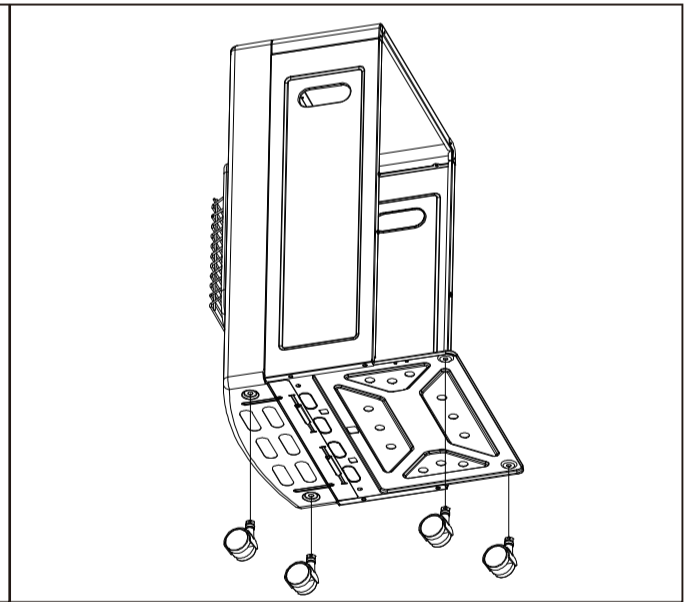

7. Put the cylinder inside the heater and fix the cylinder holder to protect the cylinder

