















MONTAGEANLEITUNG

-  MONTAGEANLEITUNG
-  ASSEMBLY INSTRUCTION
-  DE INSTRUCTIE VAN DE ASSEMBLAGE
-  ISTRUZIONE DELL'ASSEMBLEA
-  INSTRUCCIÓN DE ASAMBLEA
-  INSTRUCTION DE MONTAGE
-  NÁVOD K MONTÁŽI
-  MONTERINGSANVISNING

-  MONTAJ TALIMATI
-  ASENNUSOHJE
-  BRUGSANVISNING
-  BRUKSANVISNING
-  UPUTE ZA MONTAŽU
-  NAVODILA ZA MONTAŽO
-  SZERELÉSI ÚTMUTATÓ
-  INSTRUCTIUNI DE MONTAJ



Version 16.6

Modell-Nr.

12530

ART.-NR. FRONT KORPUS

12532  Rot (ähnl. RAL 3002)  Silber

12537  Ultramarinblau (RAL 5002)  Silber

12536  Silber  Schwarz (RAL 9005)

Friedrich Küpper GmbH
Friedrich-Küpper-Weg
54570 Berlingen
Deutschland

Telefon +49 (0) 65 91 - 95 42 0
Telefax +49 (0) 65 91 - 95 42 17
E-Mail info@friedrich-kuepper-gmbh.de
Internet www.friedrich-kuepper-gmbh.de

EINZELTEILE / PIECES

1× **A**



772 mm × 475 mm

Art.-Nr. E0154 (Silber/silver)
Art.-Nr. E0155 (Schwarz/black)

1× **B**



772 mm × 475 mm

Art.-Nr. E0165 (Silber/silver)
Art.-Nr. E0166 (Schwarz/black)

1× **C**



548 mm × 473 mm

Art.-Nr. E0179 (Silber/silver)
Art.-Nr. E0172 (Schwarz/black)

1× **D**



548 mm × 473 mm

Art.-Nr. E0184 (Silber/silver)
Art.-Nr. E0183 (Schwarz/black)

1× **E**



474 mm × 480 mm

Art.-Nr. E0194 (Silber/silver)

1× **P**



775 mm × 470 mm

Art.-Nr. E0240 (Silber/silver)
Art.-Nr. E0241 (Schwarz/black)

1× **Y**



1200 mm × 600 mm

Art.-Nr. E0255

4× **X**



450 mm × 20 mm

Art.-Nr. E0252 (Schwarz/black)

4× **H**



450 mm × 445 mm

Art.-Nr. E0215 (Silber/silver)

4× **J**



450 mm × 120 mm

Art.-Nr. E0224 (Silber/silver)

4× **I**



470 mm × 130 mm

Art.-Nr. E0221 (Silber/silver)
Art.-Nr. E0218 (Rot/red)
Art.-Nr. E0220 (Blau/blue)

BEUTELINHALT / BAG CONTENT



BENÖTIGTES WERKZEUG / NEEDED TOOLS

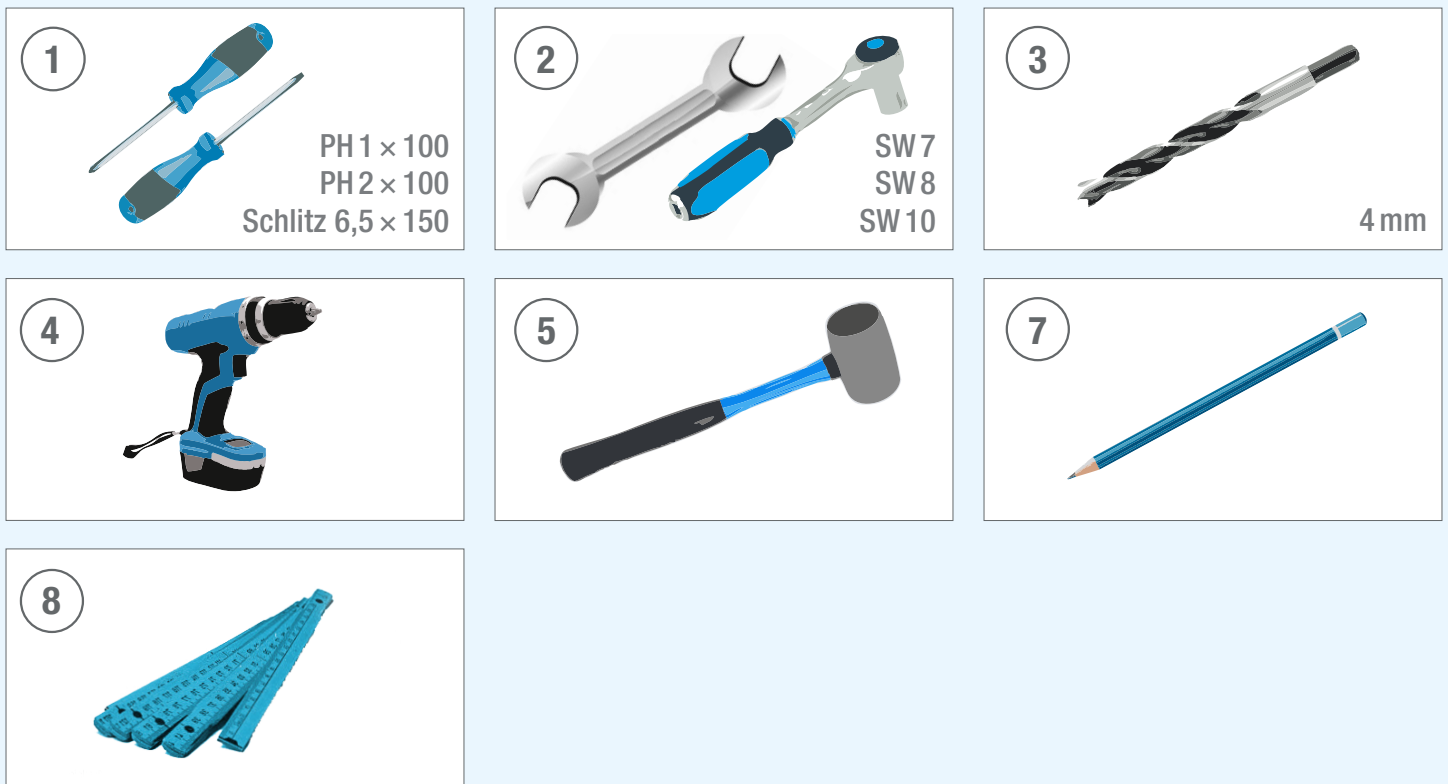

1. 2x M5 2x M5x10 2x 5,3MM

2x M5 2x M5x10 2x 5,3MM

② SW 8 ① PH2x100

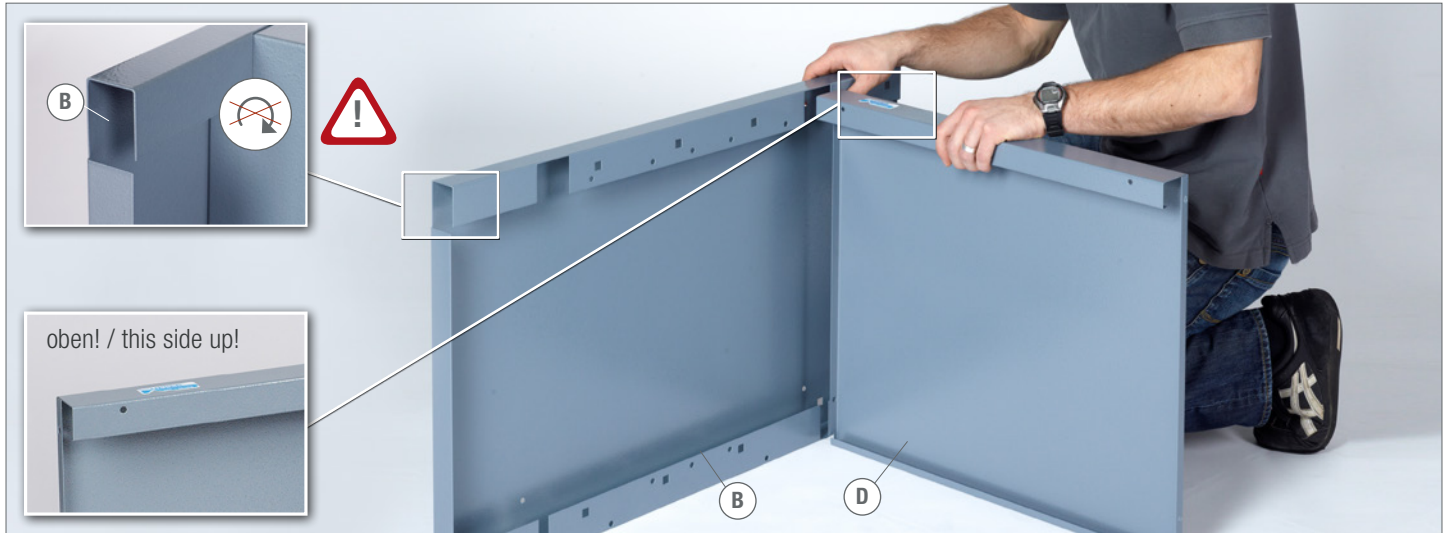

2. 2x M5 2x M5x10 2x 5,3MM

② SW 8 ① PH2x100



3. 2x M5 2x M5x10 2x 5,3MM

② SW8 ① PH2x100

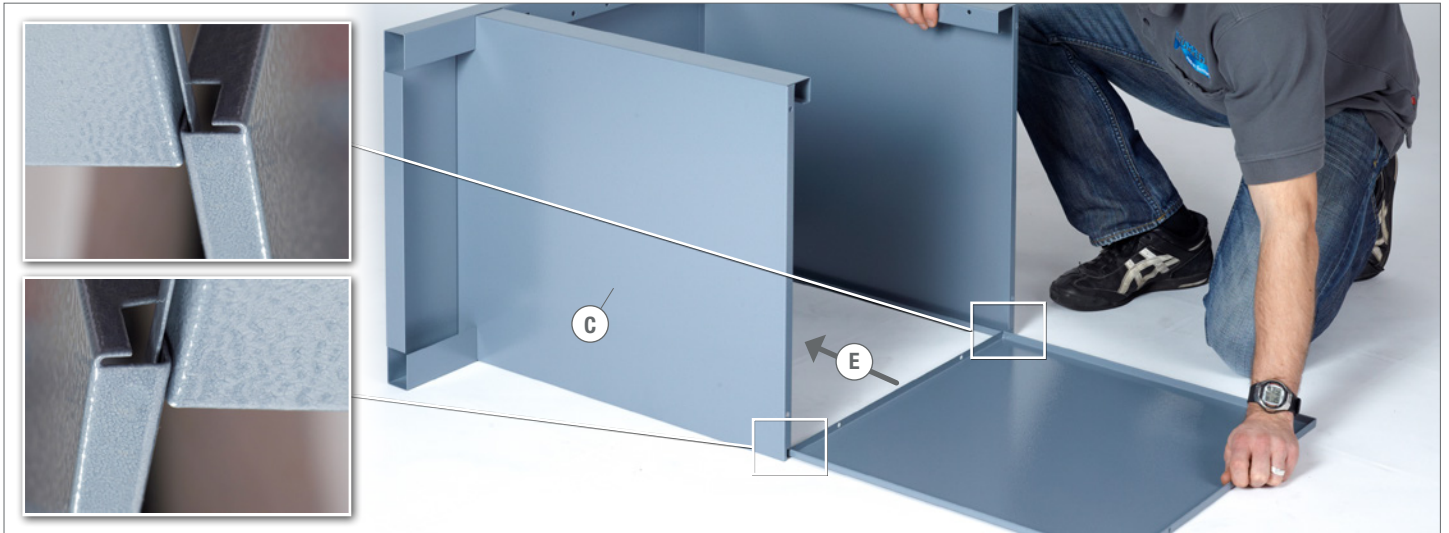

4. 6x M5 6x M5x10 6x 5,3MM ② SW8 ① PH2x100



5. 4x M8 4x 4x ⑤



6. ④ 4x CR



7. ④ 4x CL



8. 2x M8 2x 2x ⑤

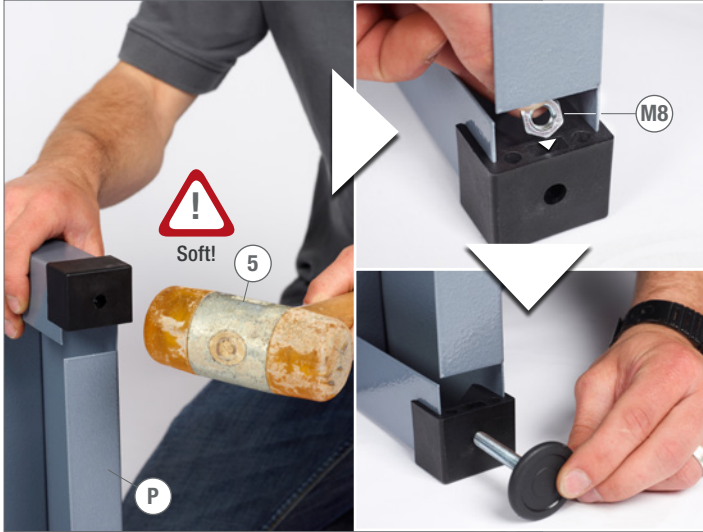

9. ⑧ ⑦

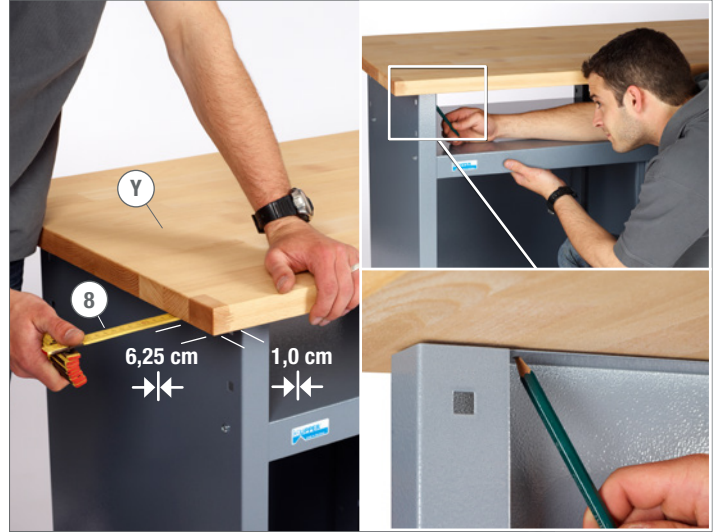

10. ⑧ ⑦



11. ④ ③



12. 10x 5,5x 19 ② SW8 ② SW8

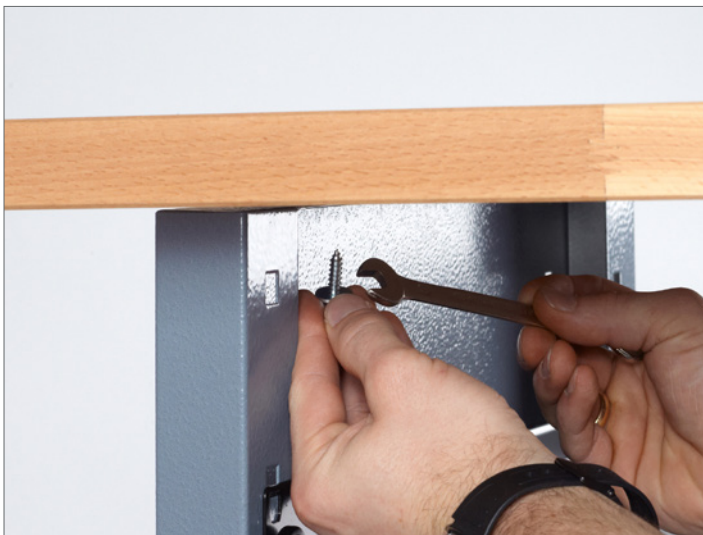

13. 8x M4 8x M4x 10 ② SW7 ① PH1x 100



14. 24x M4 24x M4 x 10

② SW7 ① PH1 x 100

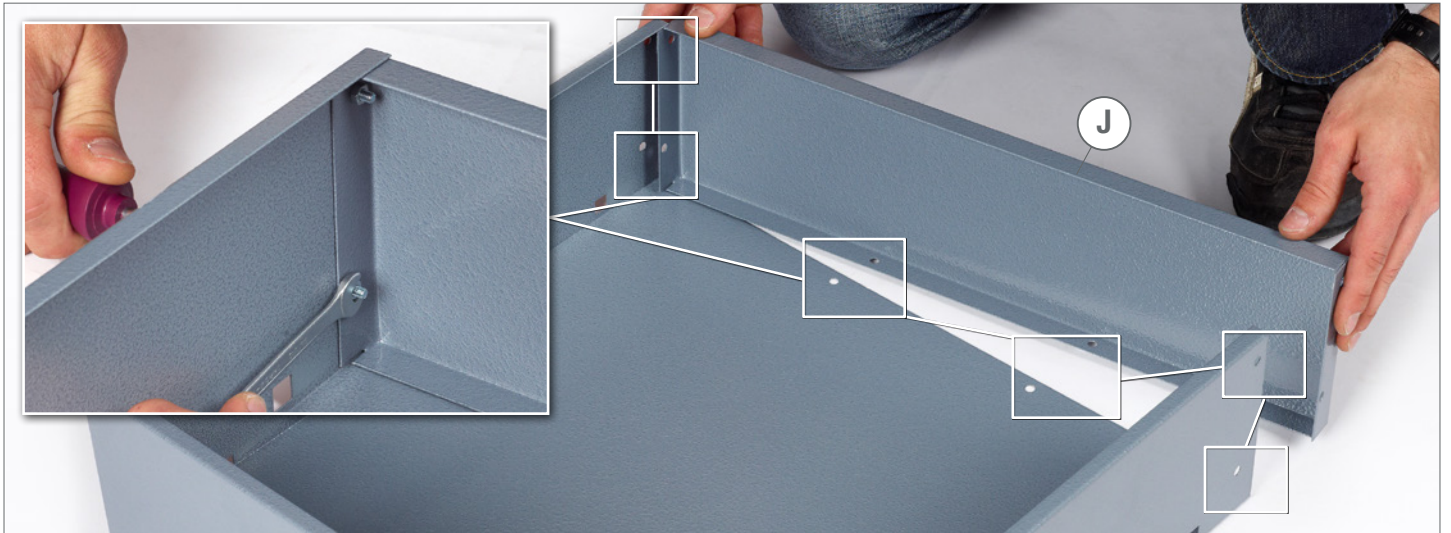

15.

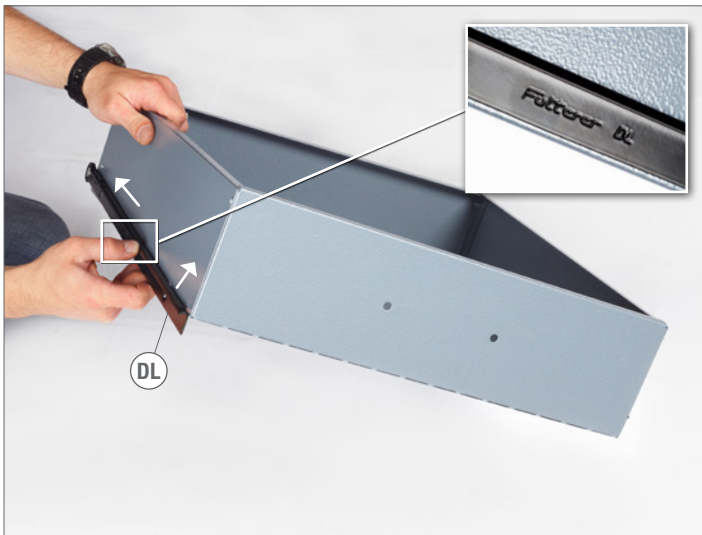

16.

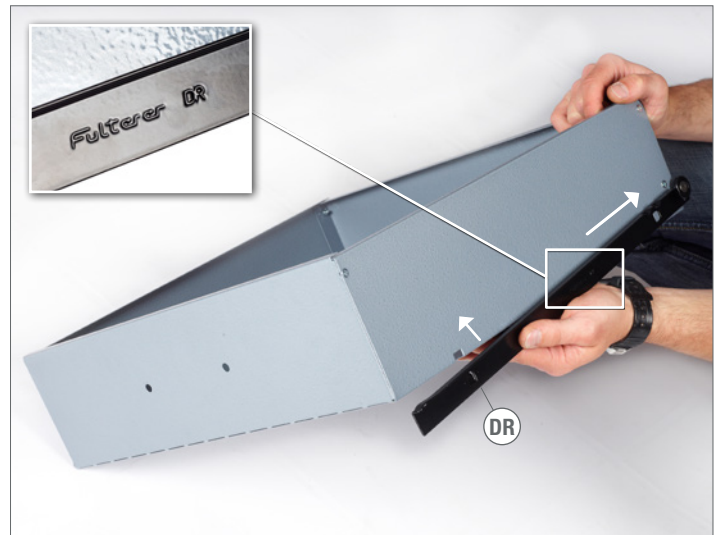

17. 8x KU 4 x 16 4x PH2 x 100



18.





Modell-Nr.

12530