

















MONTAGEANLEITUNG

-  MONTAGEANLEITUNG
-  ASSEMBLY INSTRUCTION
-  DE INSTRUCTIE VAN DE ASSEMBLAGE
-  ISTRUZIONE DELL'ASSEMBLEA
-  INSTRUCCIÓN DE ASAMBLEA
-  INSTRUCTION DE MONTAGE
-  NÁVOD K MONTÁŽI
-  MONTERINGSANVISNING

-  MONTAJ TALIMATI
-  ASENNUSOHJE
-  BRUGSANVISNING
-  BRUKSANVISNING
-  UPUTE ZA MONTAŽU
-  NAVODILA ZA MONTAŽO
-  SZERELÉSI ÚTMUTATÓ
-  INSTRUCTIUNI DE MONTAJ



Modell-Nr.

12570

ART.-NR. FRONT KORPUS

12571  Silber

12572  Silber

12574  Silber

12577  Silber

12576  

Friedrich Küpper GmbH
Friedrich-Küpper-Weg
54570 Berlingen
Deutschland

Telefon +49 (0) 65 91 - 95 42 0
Telefax +49 (0) 65 91 - 95 42 17
E-Mail info@friedrich-kuepper-gmbh.de
Internet www.friedrich-kuepper-gmbh.de

EINZELTEILE / PIECES

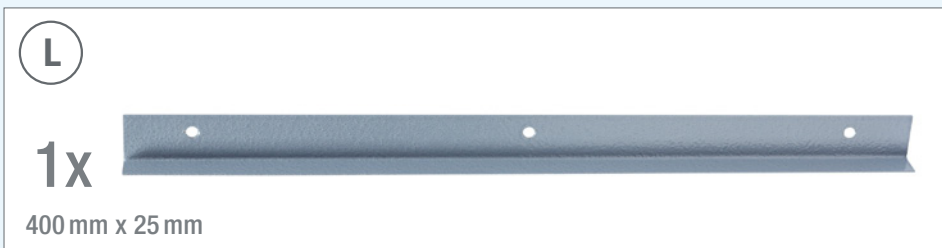
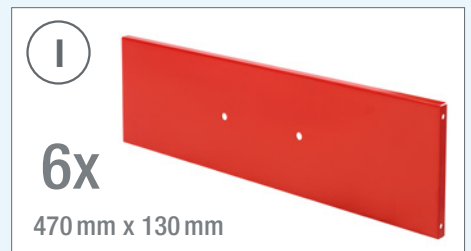
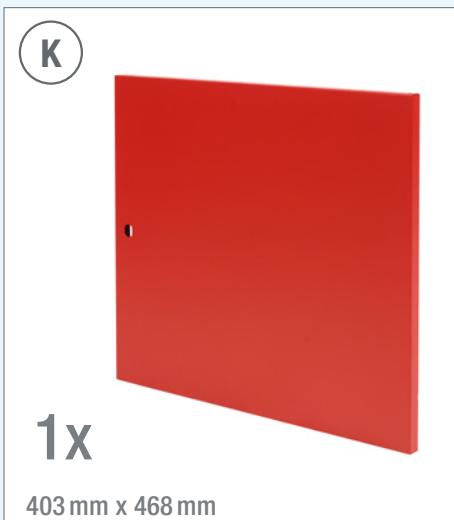
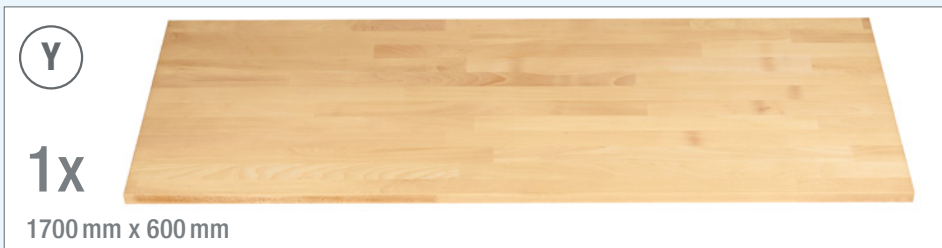
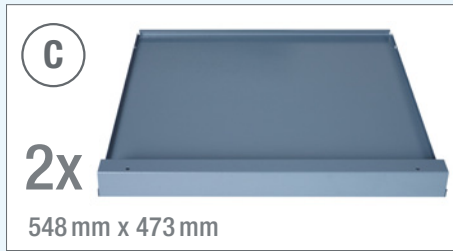

BEUTELINHALT / BAG CONTENT

 8x 5,5x19 mm	 12x KU 4x16 mm	 26x M5x10 mm	 26x ø5,3 mm	 26x M5	 48x M4 x 10 mm
 48x M4	 1x M6x16 mm	 1x ø6,4 mm	 1x M6	 1x 6x12 mm	 1x
 1x	 1x	 8x	 8x	 8x M8	 6x

BENÖTIGTES WERKZEUG / NEEDED TOOLS

 1 PH 1 x 100 PH 2 x 100 Schlitz 6,5 x 150	 2 SW 7 SW 8 SW 10	 3 4 mm
 4	 5	 6 5 mm
 7	 8	

1.



2.

2x M5 2x M5 x 10 2x 5,3 MM

② SW 8 ① PH 2 X 100

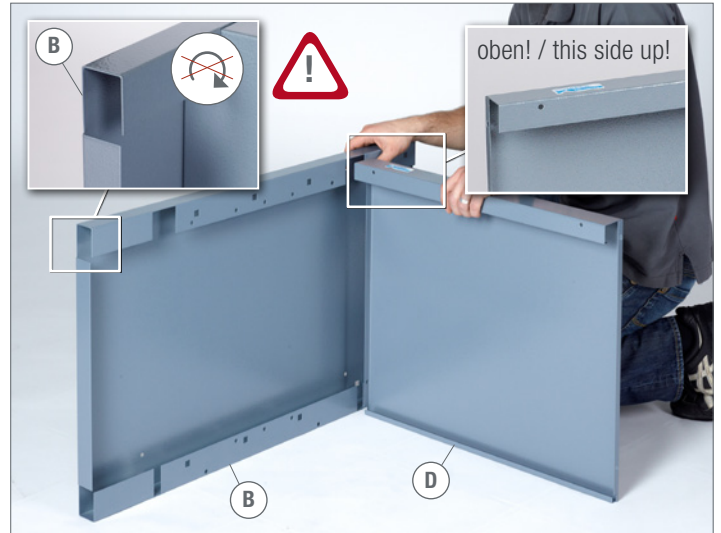

3.

2x M5 2x M5 x 10 2x 5,3 MM

② SW 8 ① PH 2 X 100



4. 2x M5 2x M5x10 2x 5,3MM

2 SW8 1 PH2X100



5. 6x M5 6x M5x10 6x 5,3MM 2 SW8 1 PH2X100



6. 4x M8 4x 4x 5 5



WIEDERHOLEN SIE DIE SCHRITTE 1 - 6 / REPEAT STEPS 1 - 6

7. 2x M5 2x M5x10 2x 5,3 MM 2 SW 8 1 PH 2X100



8. 1x CR



9. 6x CL 5x CR

8



10.

12x M4

12x M4x10

②  SW7

①  PH1x100

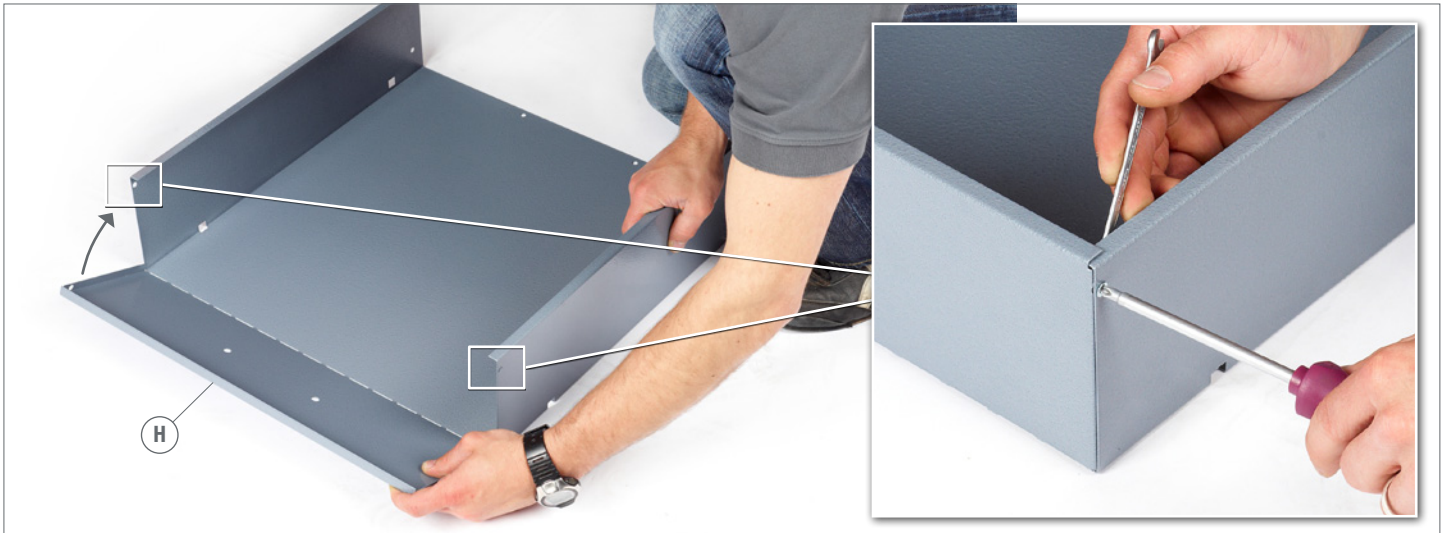

11.

36x M4

36x M4x10

②  SW7

①  PH1x100

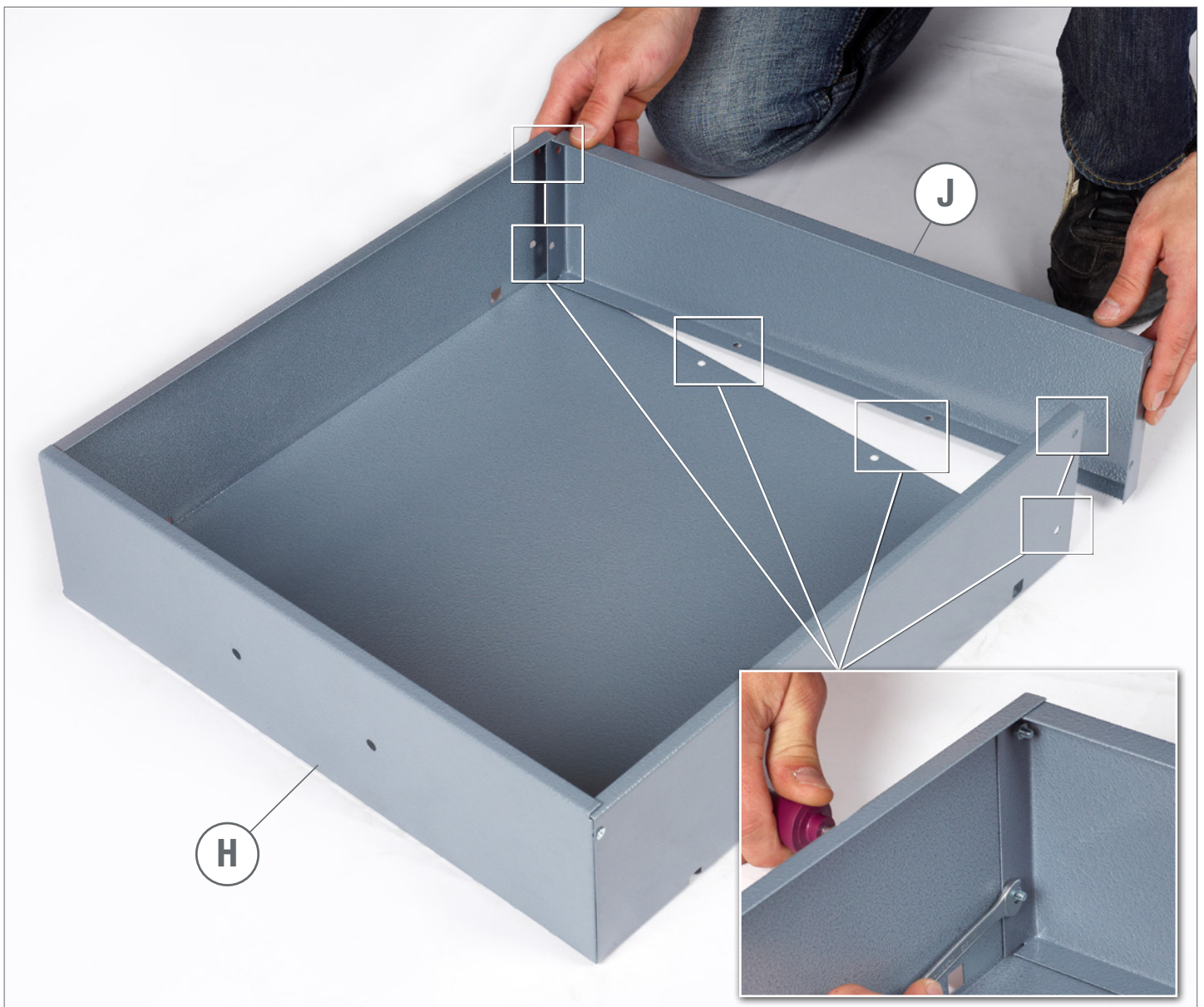

12.  6x DL  6x DR

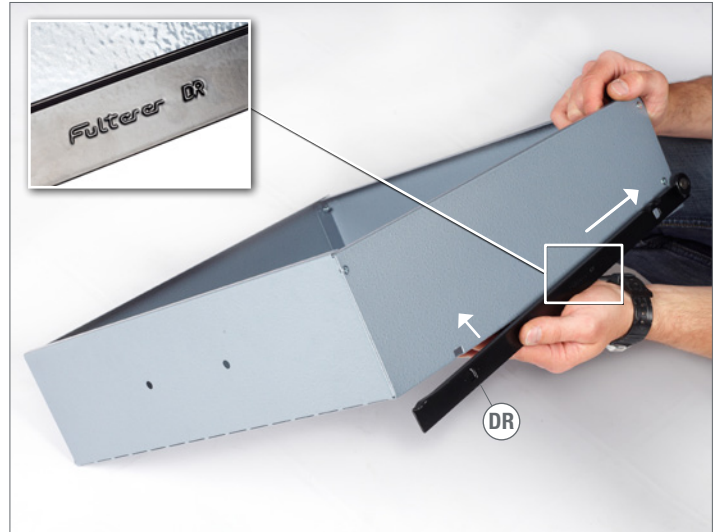
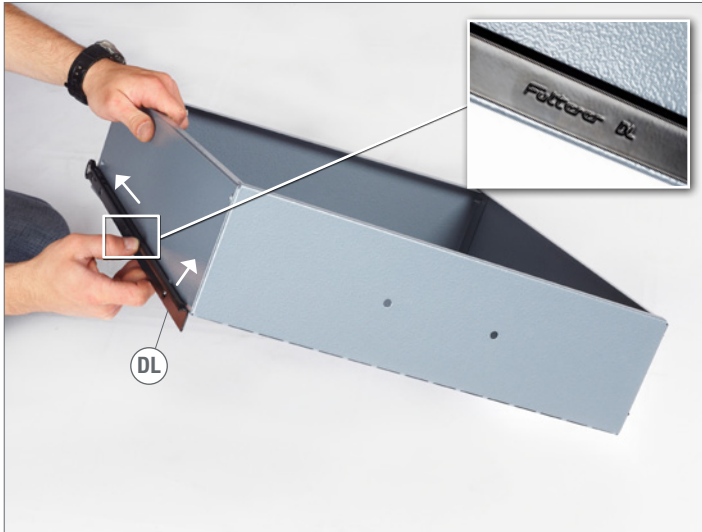

13.  12x KU 4x16  6x

 1 PH2x100



14.



15.

 8  7



16.



17.



18.



19.



1x



1x 6x12



Schlitz 6,5 x 150

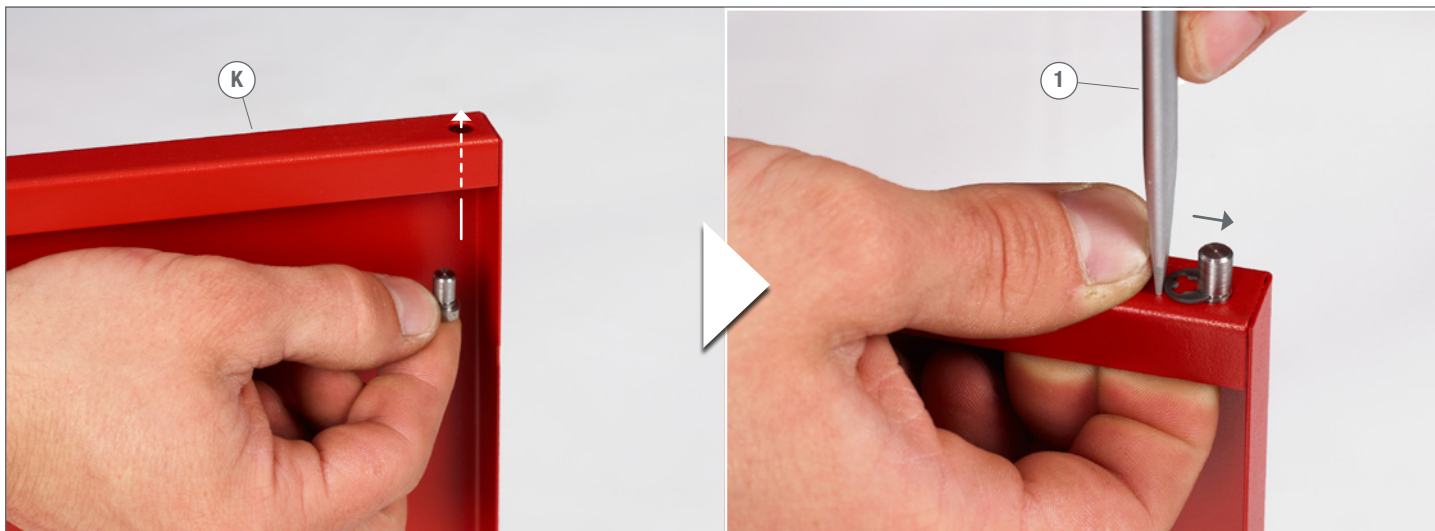

20.



21.

1x M6

1x M6x16

1x 6,4mm

2  SW 10

6 



22.





Modell-Nr.

12570