

















MONTAGEANLEITUNG

-  MONTAGEANLEITUNG
-  ASSEMBLY INSTRUCTION
-  DE INSTRUCTIE VAN DE ASSEMBLAGE
-  ISTRUZIONE DELL'ASSEMBLEA
-  INSTRUCCIÓN DE ASAMBLEA
-  INSTRUCTION DE MONTAGE
-  NÁVOD K MONTÁŽI
-  MONTERINGSANVISNING

-  MONTAJ TALIMATI
-  ASENNUSOHJE
-  BRUGSANVISNING
-  BRUKSANVISNING
-  UPUTE ZA MONTAŽU
-  NAVODILA ZA MONTAŽO
-  SZERELÉSI ÚTMUTATÓ
-  INSTRUCTIUNI DE MONTAJ



Modell-Nr.

12050

ART.-NR. FRONT KORPUS

12051  Silber

12052  Silber

12054  Silber

12057  Silber

12056  

Friedrich Küpper GmbH
Friedrich-Küpper-Weg
54570 Berlingen
Deutschland

Telefon +49 (0) 65 91 - 95 42 0
Telefax +49 (0) 65 91 - 95 42 17
E-Mail info@friedrich-kuepper-gmbh.de
Internet www.friedrich-kuepper-gmbh.de

EINZELTEILE / PIECES

A

1x

772 mm x 475 mm



C

1x

1057 mm x 473 mm



B

1x

772 mm x 475 mm



D

1x

1057 mm x 473 mm



F

1x

645 mm x 450 mm



E

1x

985 mm x 480 mm



K

2x

403 mm x 468 mm



Y

1x

1200 mm x 600 mm



L

2x

400 mm x 25 mm

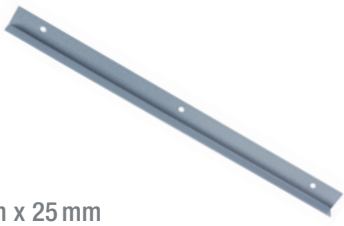

J

2x

450 mm x 120 mm



X

2x

450 mm x 20 mm



H

2x

450 mm x 445 mm



I

2x

470 mm x 130 mm



BEUTELINHALT / BAG CONTENT

 6x 5,5x19 mm	 4x KU 4x16 mm	 20x M5x10 mm	 20x ø5,3 mm	 20x M5	 16x M4 x 10 mm
 16x M4	 2x M6x16 mm	 2x ø6,4 mm	 2x M6	 2x 6x12 mm	 2x
 2x	 2x	 4x	 4x	 4x M8	 2x

BENÖTIGTES WERKZEUG / NEEDED TOOLS

 ① PH 1x100 PH 2x100 Schlitz 6,5x150	 ② SW 7 SW 8 SW 10	 ③ 4 mm
 ④	 ⑤	 ⑥ 5 mm
 ⑦	 ⑧	

1.



2. WICHTIG / IMPORTANT



3.  2x M5  2x M5 x 10  2x 5,3 MM

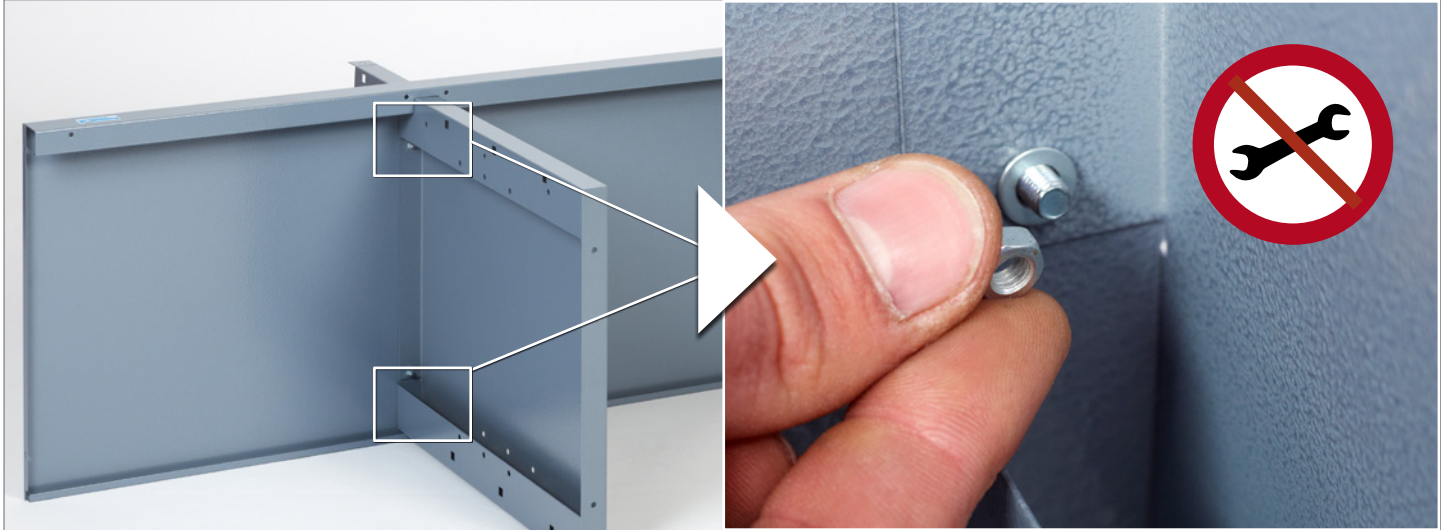

4.



5.  2x M5  2x M5 x 10  2x 5,3 MM  ② SW 8  ① PH 2 X 100

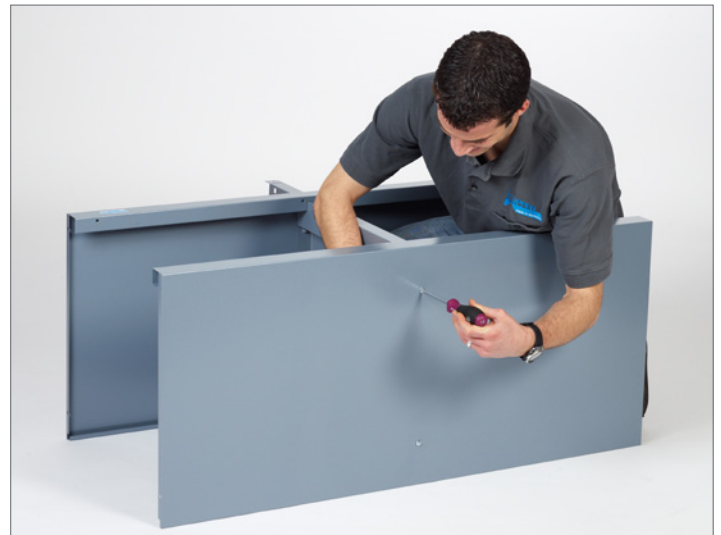

6.



7.

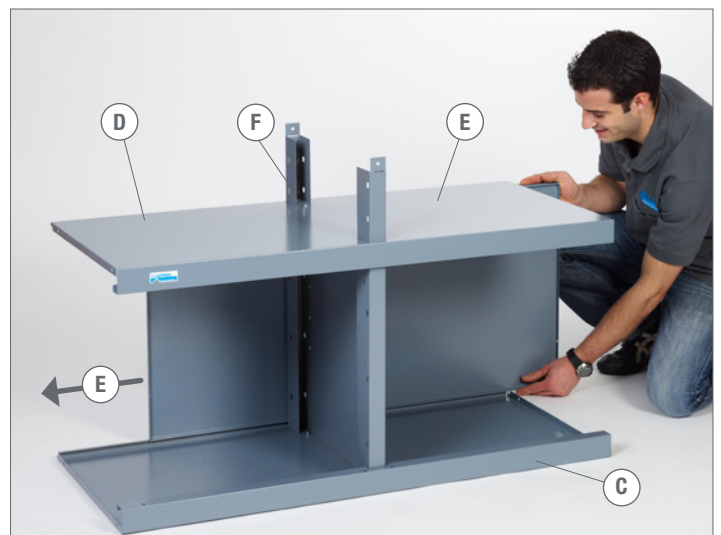

ZU SCHRITT 3. / IN ADDITION TO STEP 3.

②  SW 8 ①  PH 2x100

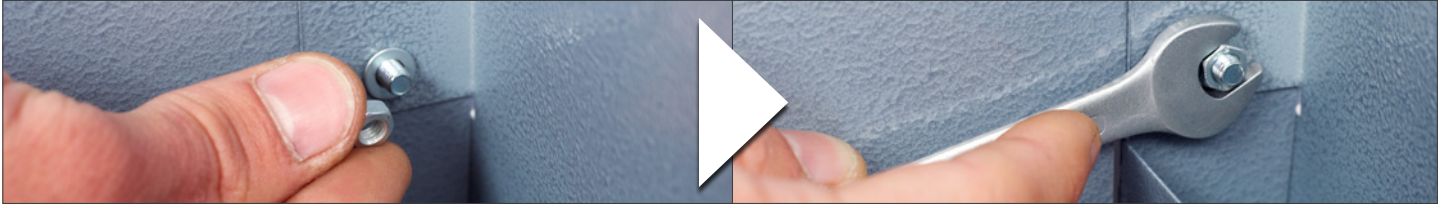

8. WICHTIG / IMPORTANT



9. WICHTIG / IMPORTANT



10.  6x M5  6x M5 x 10  6x 5,3MM ②  SW 8 ①  PH 2x100



11.  6x M5  6x M5 x 10  6x 5,3MM ②  SW 8 ①  PH 2x100



12.

4x M8 4x 4x 4x

5



13.

4x M5 4x M5 x 10 4x 5,3 mm

2 SW 8 1 PH 2 x 100

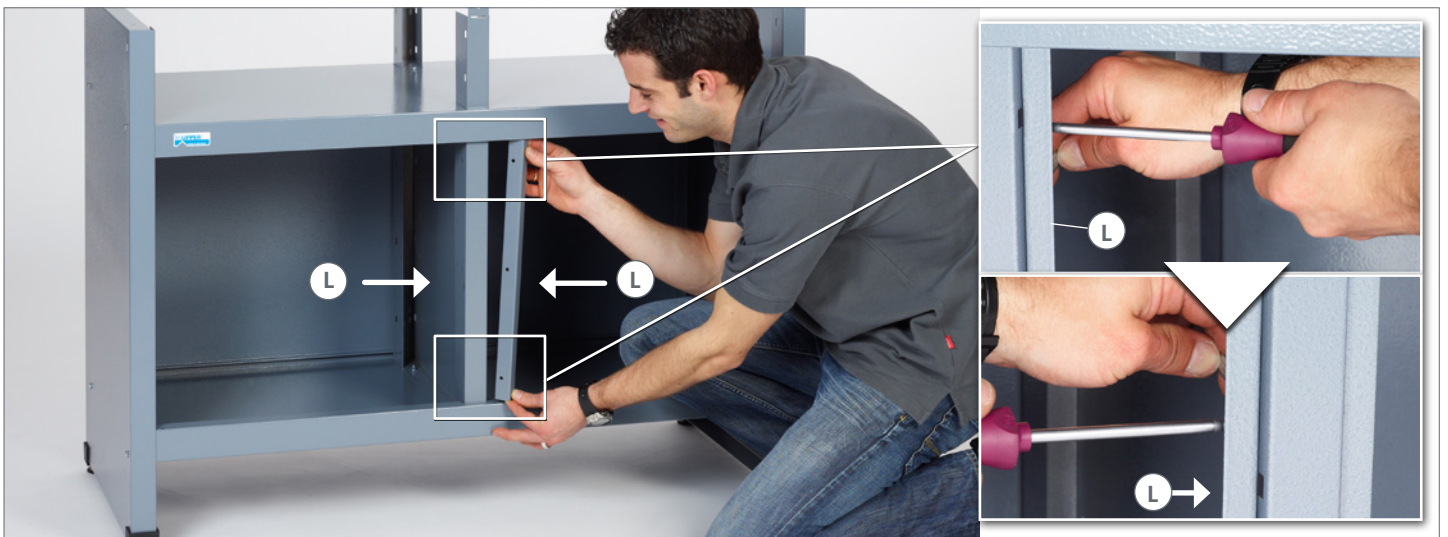

14.

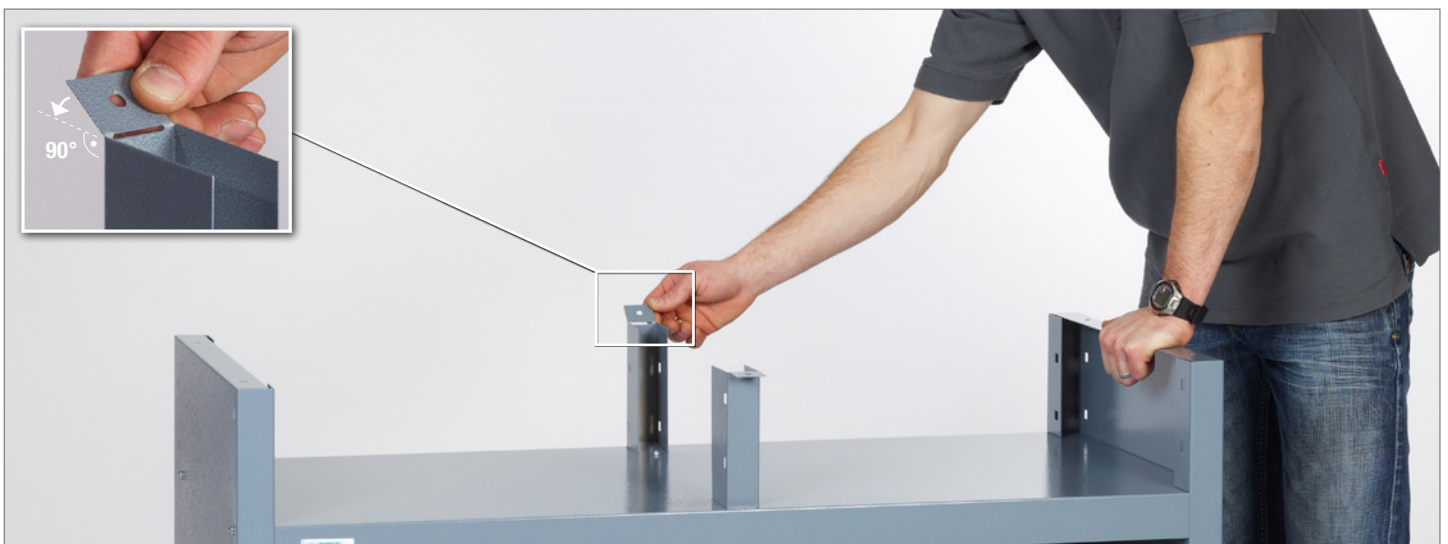

15.  2x  2x 6 x 12

①  Schlitz 6,5 x 150

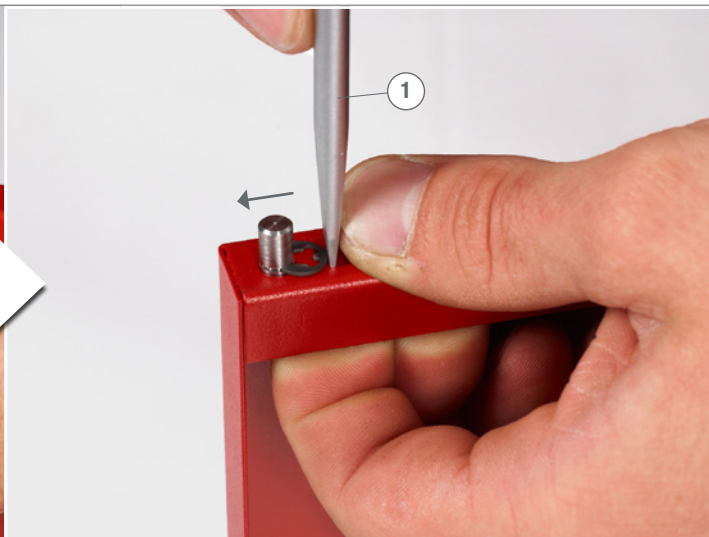

16.

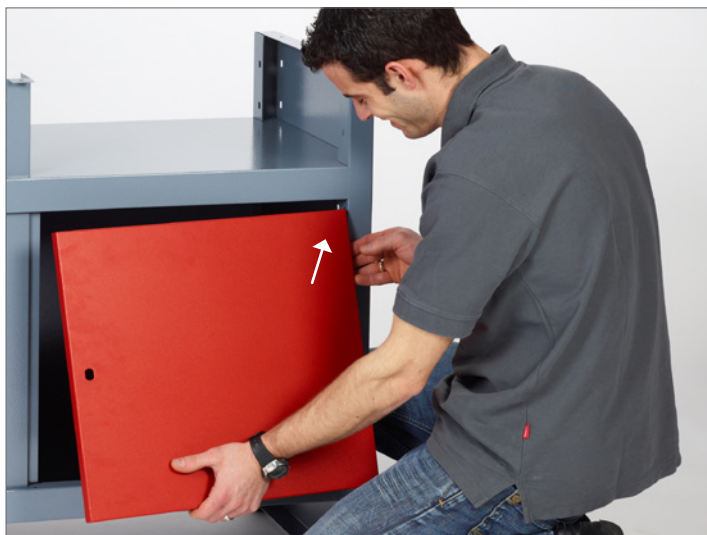

17.  2x M6  2x M6 x 16  2x 6,4 mm ②  SW 10 ⑥ 

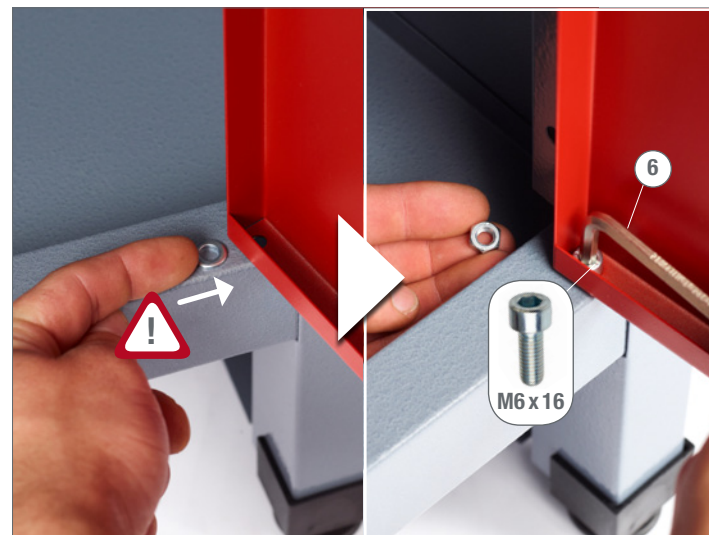

18.  2x  2x

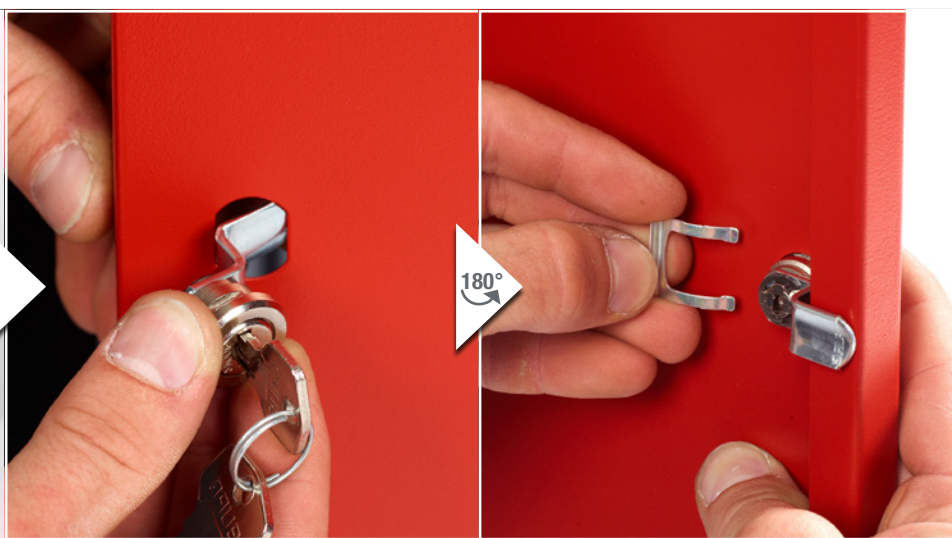

19.

8  7 

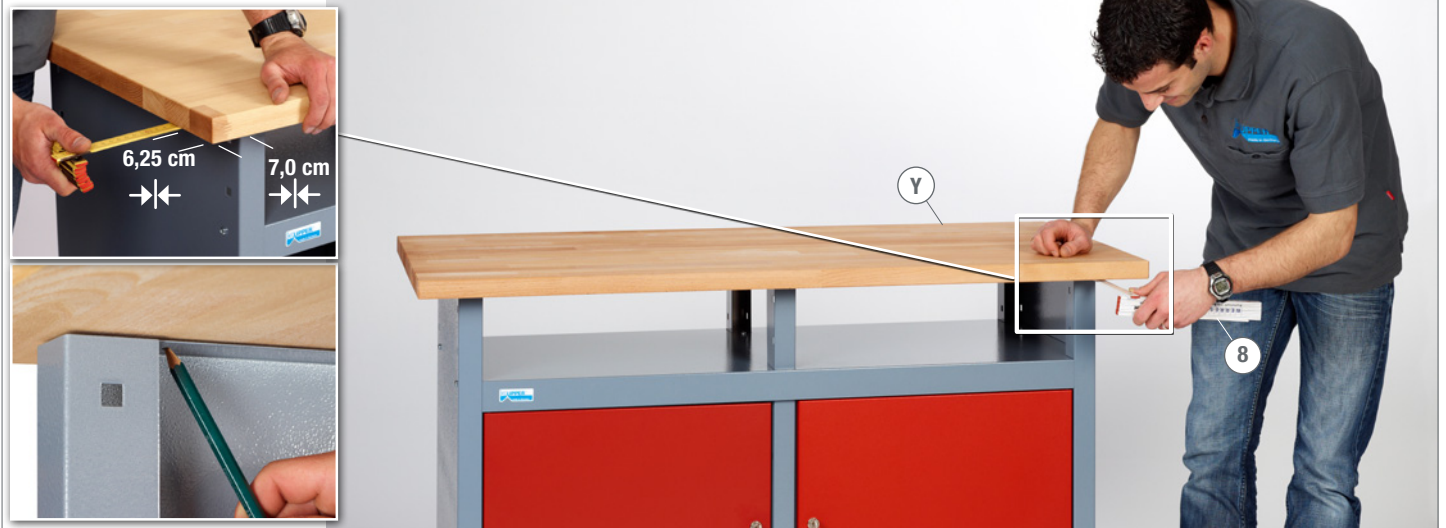

20.

4  3 



21.

 6x 5,5 x 19

2  SW 8 2  SW 8



22.  2x CR



23.  2x CL



24.

4x M4

4x M4 x 10

② SW7

① PH1 x 100



25.

12x M4

12x M4 x 10

② SW7

① PH1 x 100

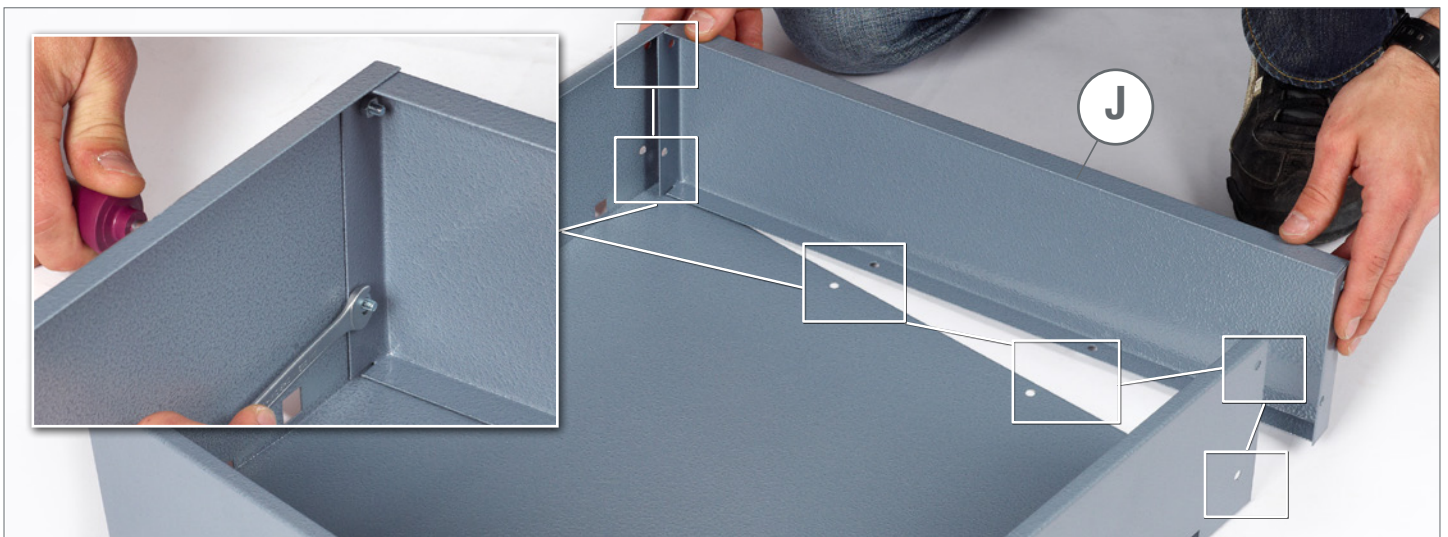

26.

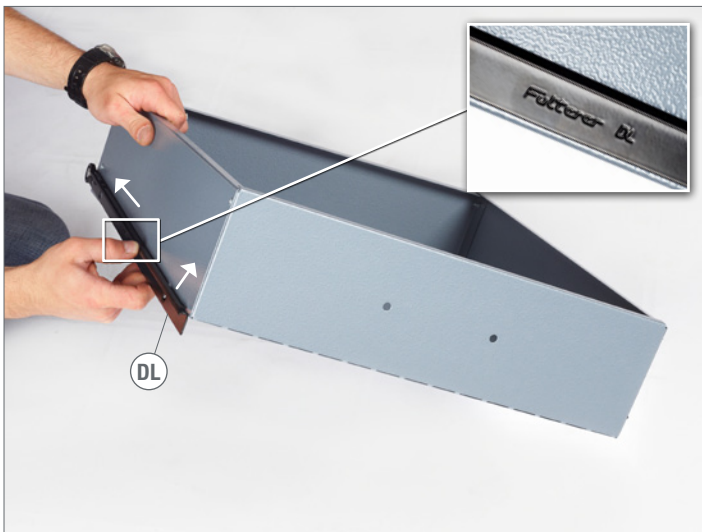

27.

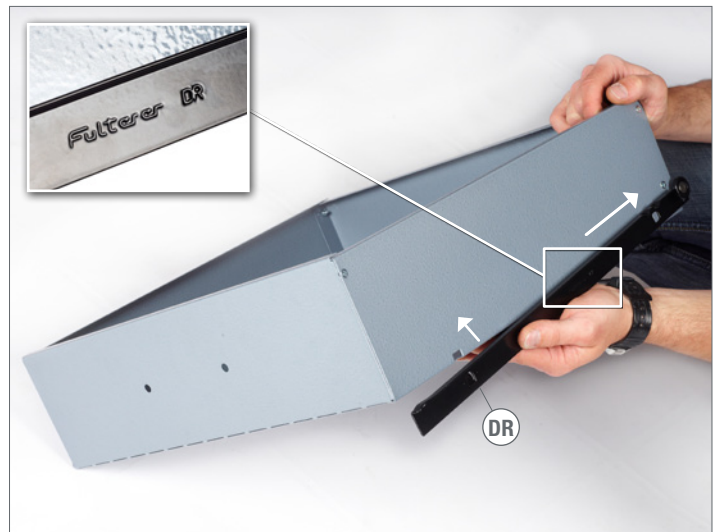

28.



29.

4x KU 4x16

2x



① PH2x100



30.





Modell-Nr.

12050