

















MONTAGEANLEITUNG

-  MONTAGEANLEITUNG
-  ASSEMBLY INSTRUCTION
-  DE INSTRUCTIE VAN DE ASSEMBLAGE
-  ISTRUZIONE DELL'ASSEMBLEA
-  INSTRUCCIÓN DE ASAMBLEA
-  INSTRUCTION DE MONTAGE
-  NÁVOD K MONTÁŽI
-  MONTERINGSANVISNING

-  MONTAJ TALIMATI
-  ASENNUSOHJE
-  BRUGSANVISNING
-  BRUKSANVISNING
-  UPUTE ZA MONTAŽU
-  NAVODILA ZA MONTAŽO
-  SZERELÉSI ÚTMUTATÓ
-  INSTRUCTIUNI DE MONTAJ



Modell-Nr.

12240

ART.-NR. FRONT KORPUS

12241  Silber

12242  Silber

12244  Silber

12247  Silber

12246  

Friedrich Küpper GmbH
Friedrich-Küpper-Weg
54570 Berlingen
Deutschland

Telefon +49 (0) 65 91 - 95 42 0
Telefax +49 (0) 65 91 - 95 42 17
E-Mail info@friedrich-kuepper-gmbh.de
Internet www.friedrich-kuepper-gmbh.de

EINZELTEILE / PIECES

A

1x

772 mm x 475 mm



C

1x

1057 mm x 473 mm



B

1x

772 mm x 475 mm



D

1x

1057 mm x 473 mm



F

1x

645 mm x 450 mm



E

1x

985 mm x 480 mm



K

1x

403 mm x 468 mm



Y

1x

1200 mm x 600 mm



L

1x

400 mm x 25 mm

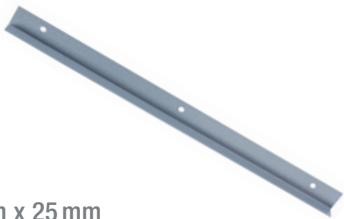

J

4x

450 mm x 120 mm



X

6x

450 mm x 20 mm



H

4x

450 mm x 445 mm



I

4x

470 mm x 130 mm



V

2x

450 mm x 440 mm



W

2x

470 mm x 65 mm



BEUTELINHALT / BAG CONTENT

 6x 5,5x 19 mm	 12x KU 4 x 16 mm	 18x M5 x 10 mm	 18x ø 5,3 mm	 18x M5	 32x M4 x 10 mm
 32x M4	 1x M6 x 16 mm	 1x ø 6,4 mm	 1x M6	 1x 6 x 12 mm	 1x
 1x	 1x	 4x	 4x	 4x M8	 6x

BENÖTIGTES WERKZEUG / NEEDED TOOLS

 1 PH 1 x 100 PH 2 x 100 Schlitz 6,5 x 150	 2 SW 7 SW 8 SW 10	 3 4 mm
 4	 5	 6 5 mm
 7	 8	

1.



2. WICHTIG / IMPORTANT



3.  2x M5  2x M5 x 10  2x 5,3 MM

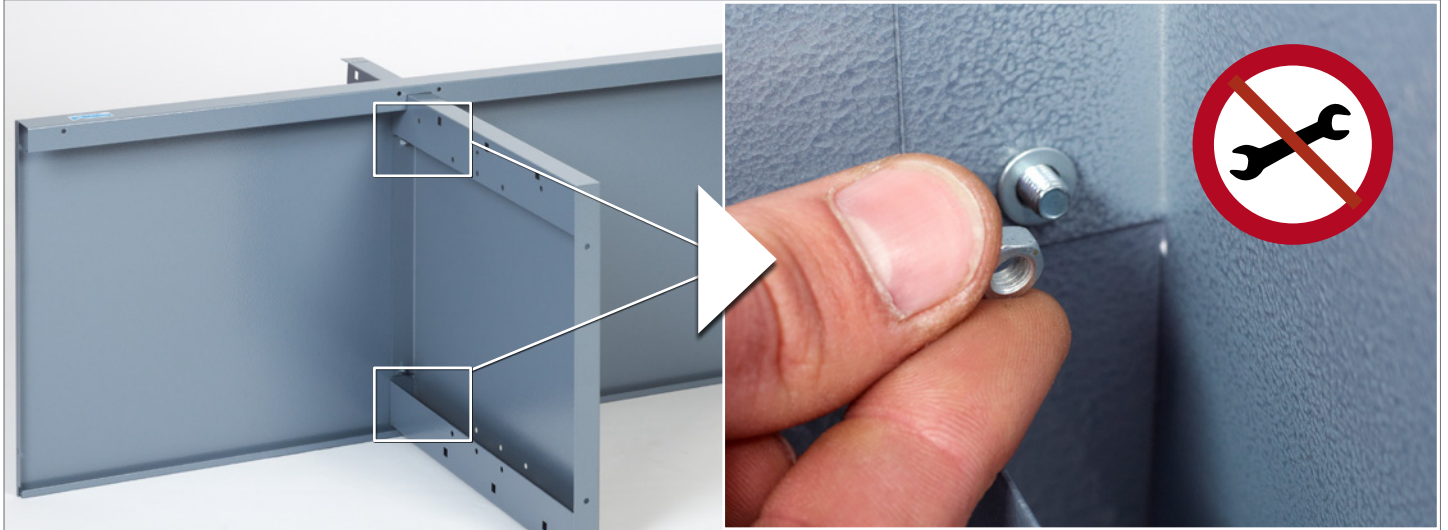

4.



5.  2x M5  2x M5 x 10  2x 5,3 MM  ② SW 8  ① PH 2 X 100



6.



7.

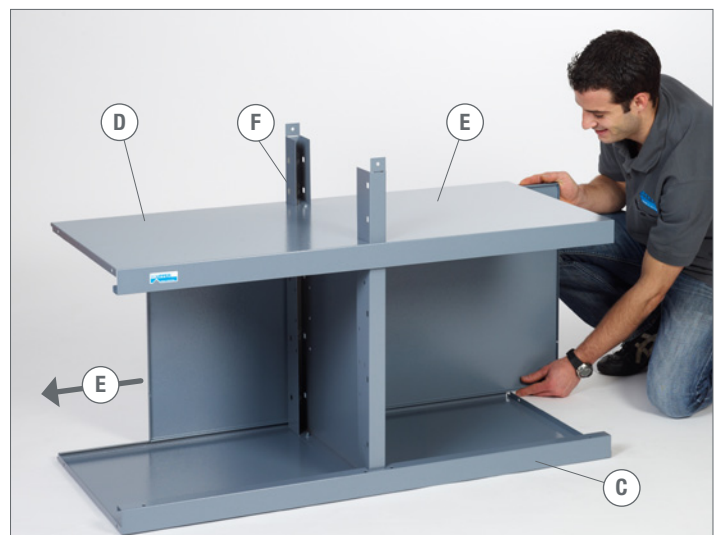

ZU SCHRITT 3. / IN ADDITION TO STEP 3.

②  SW 8 ①  PH 2x100

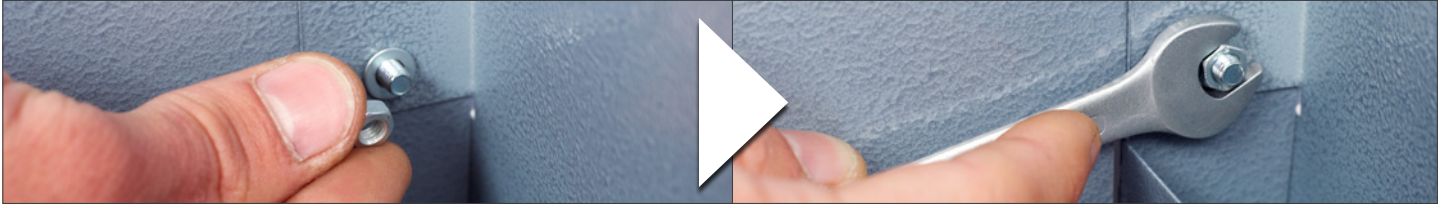

8. WICHTIG / IMPORTANT



9. WICHTIG / IMPORTANT



10.  6x M5  6x M5 x 10  6x 5,3MM ②  SW 8 ①  PH 2x100

11.  6x M5  6x M5 x 10  6x 5,3MM ②  SW 8 ①  PH 2x100



12.

4x M8 4x 4x 4x

5



13.

2x M5 2x M5 x 10 2x 5,3 mm

2 SW 8 1 PH 2 x 100

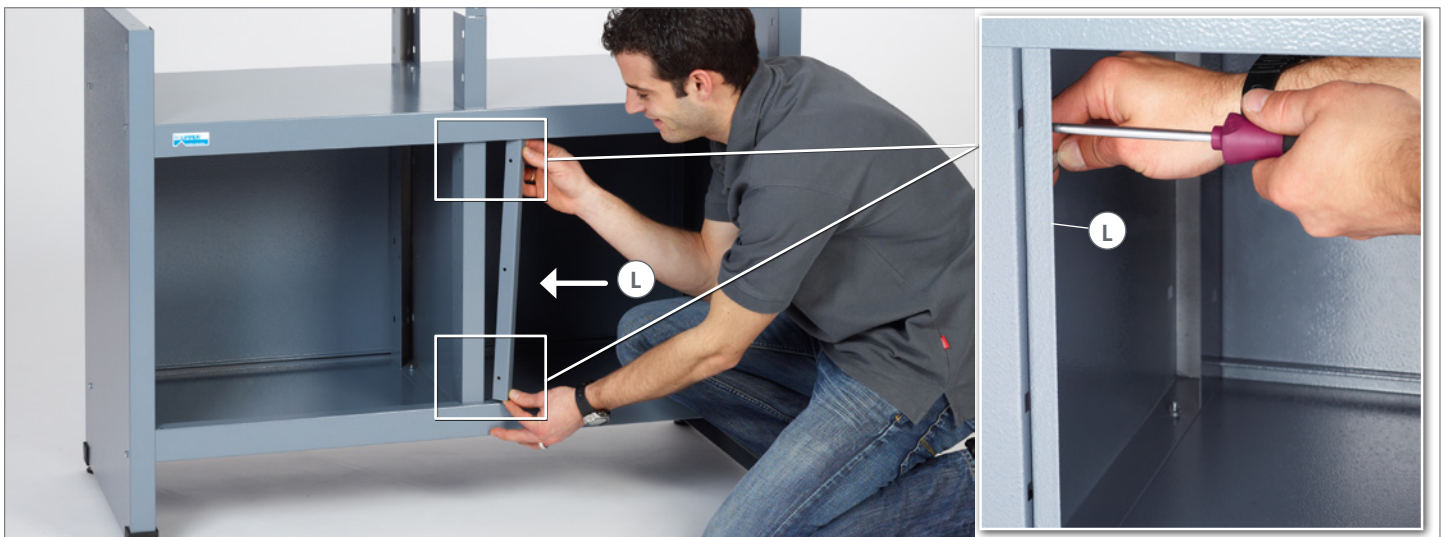

14.





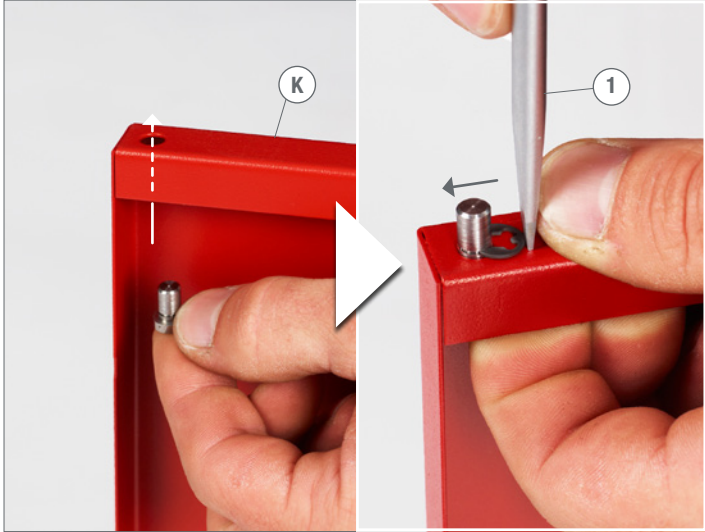

15.  1x  1x 6x12  ① Schlitz 6,5 x 150



16.



17.  1x M6  1x M6 x 16  1x 6,4 mm  ② SW 10  ⑥

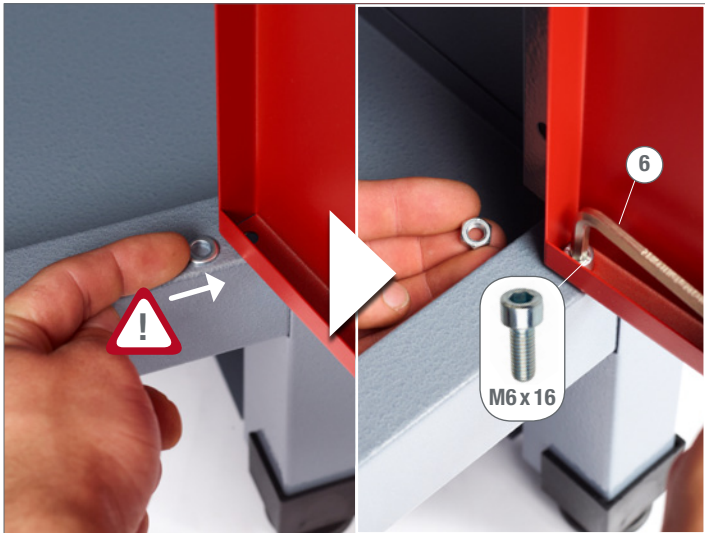

18.  1x  1x

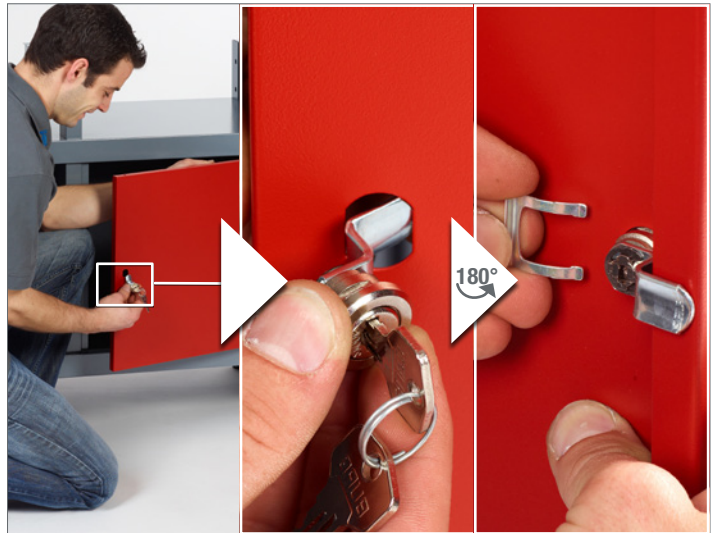

19.  ⑧  ⑦



20.



21.

6x 5,5x19



22.

6x CR



23.

6x CL

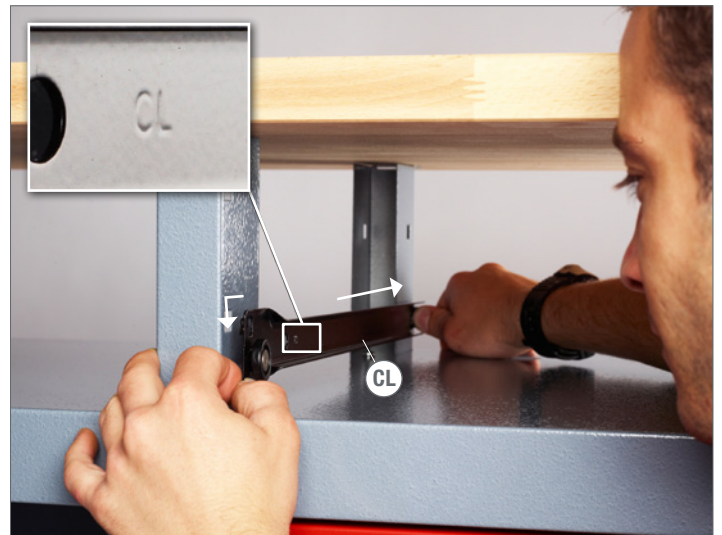

24.

4x KU 4x16

2x



1 PH1x100

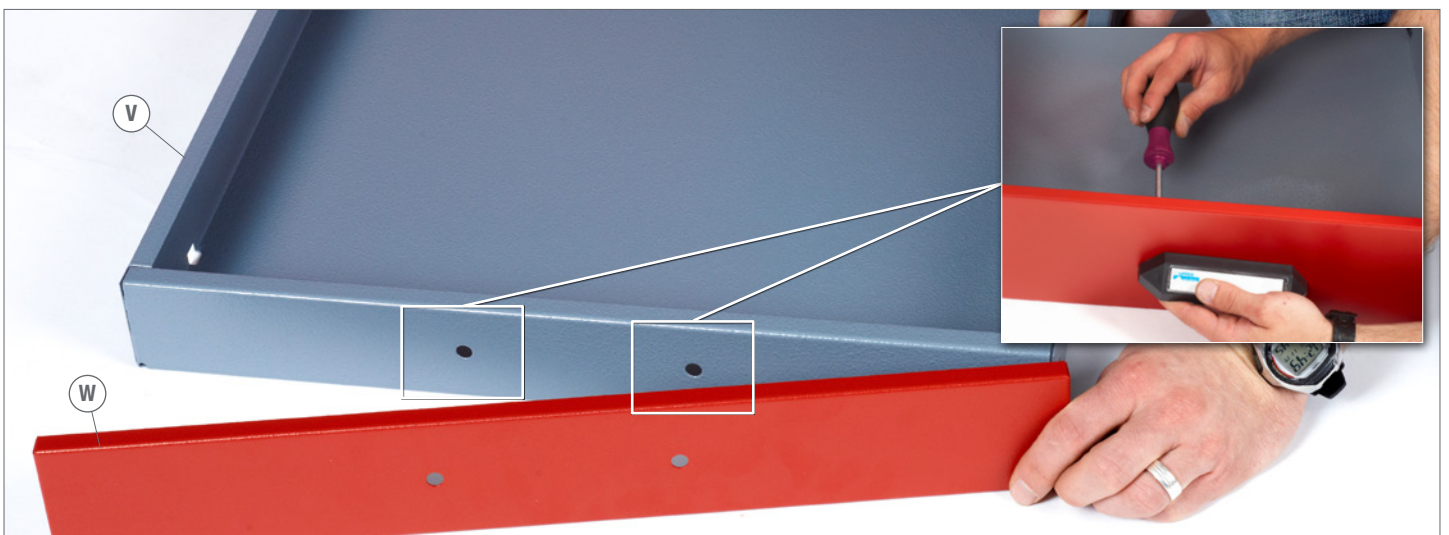

25.

8x M4

8x M4 x10

② SW7

① PH1x100



26.

24x M4

24x M4 x10

② SW7

① PH1x100

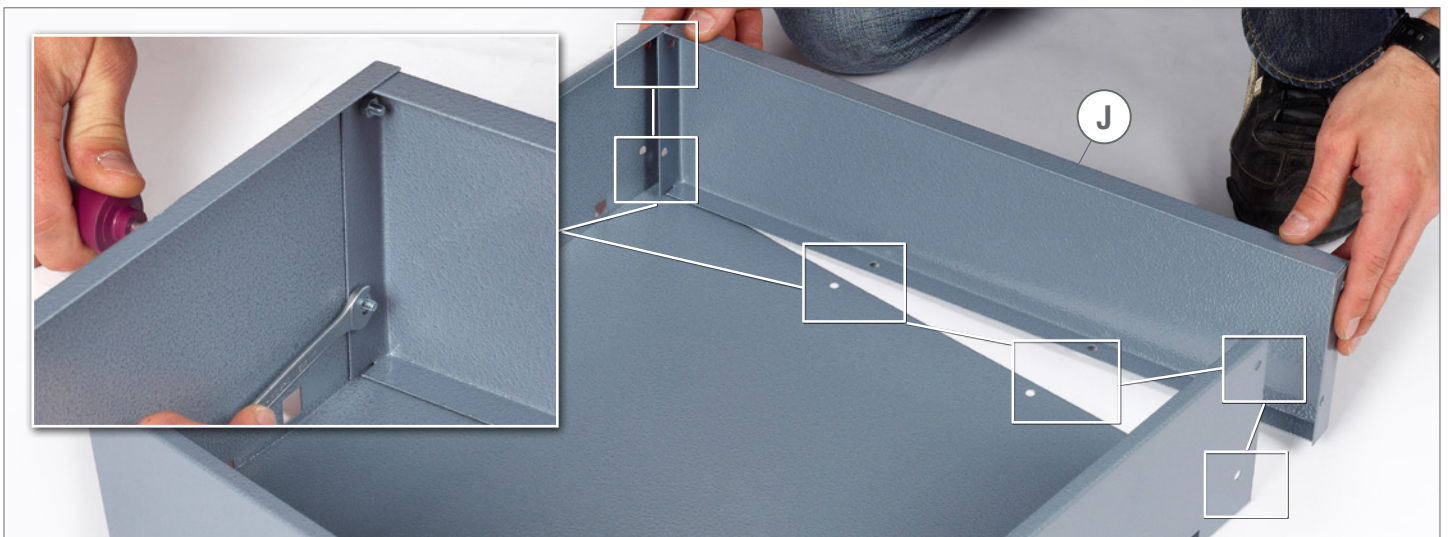

27.



28.

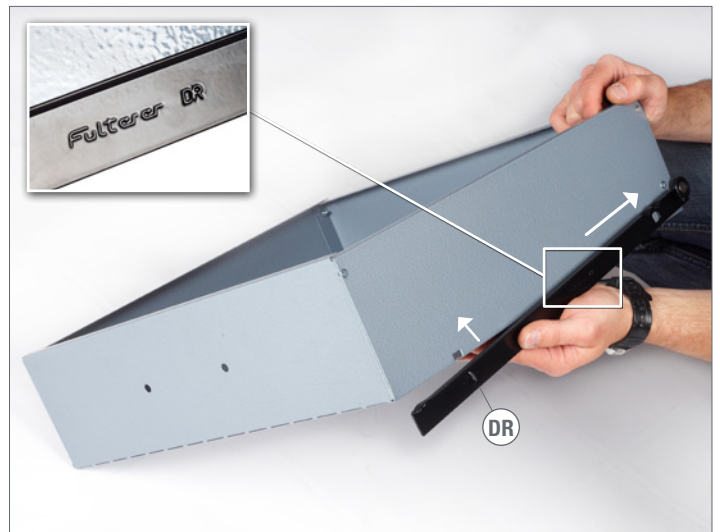

29.



30.

8x KU 4x16

4x



① PH2x100



31.





Modell-Nr.

12240